

TUBES ET RACCORDS AUTOBLOQUANTS

P-1



TEMPÉRATURE DE TRAVAIL

P.....32°F A 140°F
HP.....0°F A 200°F

PRESSION DE TRAVAIL MAX

P.....150 PSIG
HP.....300 PSIG

LES ITEMS EN BLEU SONT DES ITEMS MOINS COURANTS

UNION SAE

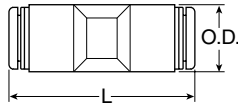

Part No.	Tube Size	O.D.	L
P.0190	1/8	0.433	1.299
P.0195	5/32	0.433	1.300
P.0196	3/16	0.512	1.535
P.0200	1/4	0.560	1.570
P.0205	5/16	0.610	1.614
P.0210	3/8	0.728	1.890
P.0215	1/2	0.866	2.362

UNION METRIQUE

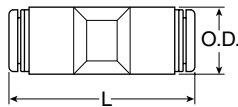

Part No.	Tube Size (mm)	O.D. (mm)	L (mm)
P.1230	4	11.00	33.00
P.1235	6	13.00	39.00
P.1240	8	15.50	41.00
P.1245	10	18.50	48.00
P.1250	12	22.00	60.00

RACCORD FEMELLE NPT

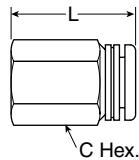

Part No.	Tube Size	NPT	C Hex.	L
P.0801	3/16	1/8	1/2	1.12
P.0804	1/4	1/8	1/2	1.11
P.0805	1/4	1/4	5/8	1.31
P.0802	5/32	1/8	1/2	1.07
P.0803	5/32	1/4	5/8	1.26
P.0806	5/16	1/8	9/16	1.17
P.0807	5/16	1/4	5/8	1.33
P.0809	3/8	1/4	13/16	1.40
P.0810	3/8	3/8	13/16	1.45

RACCORD MALE SAE

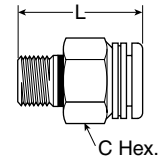

Part No.	Tube Size	UNF	C Hex.	L
P.0101	1/8	10-32	1/2	0.925
P.0115	5/32	10-32	1/2	0.913
P.0126	3/16	10-32	9/16	0.898
P.0128	1/4	10-32	9/16	0.898

RACCORD MALE NPT

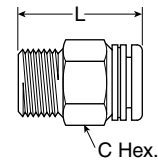

Part No.	Tube Size	NPT	C Hex.	L
P.0100	1/8	1/16	1/2	0.945
P.0105	1/8	1/8	1/2	0.945
P.0106	1/8	1/4	9/16	1.150
P.0116	5/32	1/16	1/2	0.937
P.0120	5/32	1/8	1/2	0.937
P.0125	5/32	1/4	9/16	1.142
P.0127	3/16	1/8	9/16	0.980
P.0128	3/16	1/4	9/16	1.181
P.0129	1/4	1/16	9/16	1.134
P.0130	1/4	1/8	9/16	0.980
P.0135	1/4	1/4	9/16	1.181
P.0140	1/4	3/8	13/16	1.185
P.0145	5/16	1/8	5/8	1.340
P.0150	5/16	1/4	5/8	1.357
P.0155	5/16	3/8	13/16	1.347
P.0159	3/8	1/8	13/16	1.319
P.0160	3/8	1/4	13/16	1.437
P.0165	3/8	3/8	13/16	1.437
P.0170	3/8	1/2	15/16	1.630
P.0175	1/2	1/4	15/16	1.555
P.0180	1/2	3/8	15/16	1.547
P.0185	1/2	1/2	15/16	1.724

RACCORD MALE BSPT

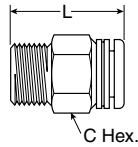

Part No.	Tube Size (mm)	BSPT	C Hex. (mm)	L (mm)
P.1105	4	1/8	12	21.0
P.1110	4	1/4	14	18.5
P.1130	6	1/8	14	22.0
P.1135	6	1/4	14	22.8
P.1140	8	1/8	17	26.0
P.1145	8	1/4	17	23.5
P.1150	8	3/8	17	22.6
P.1155	10	1/4	21	31.5
P.1160	10	3/8	21	29.0
P.1161	10	1/2	22	28.0
P.1163	12	1/4	22	33.8
P.1165	12	3/8	22	31.8
P.1170	12	1/2	22	33.8

RACCORD MALE BSPP

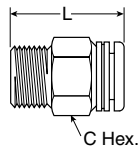

Part No.	Tube Size (mm)	BSPP	C Hex. (mm)	L (mm)
P.3105	4	1/8	12	22.0
P.3110	4	1/4	14	20.0
P.3130	6	1/8	14	27.5
P.3135	6	1/4	14	27.0
P.3140	8	1/8	17	28.8
P.3145	8	1/4	17	28.8
P.3150	8	3/8	21	28.8
P.3155	10	1/4	21	37.0
P.3160	10	3/8	21	34.0
P.3161	10	1/2	24	36.0
P.3163	12	1/4	22	37.7
P.3165	12	3/8	22	33.7
P.3170	12	1/2	24	35.7

RACCORD MALE METRIQUE

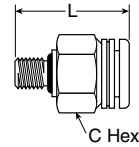

Part No.	Tube Size (mm)	Metric	C Hex. (mm)	L (mm)
P.1100	4	M5	12	22.0
P.1115	6	M5	14	27.5
P.1116	6	M10	14	25.0
P.1117	6	M12	17	26.5
P.1118	8	M12	17	28.3
P.1119	8	M16	21	29.8

UNION EN T SAE

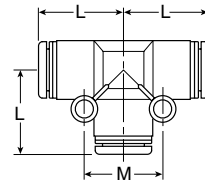

Part No.	Tube Size	Mounting Hole Dia.	L	M
P.0420	1/8	*	0.689	*
P.0425	5/32	*	0.689	*
P.0426	3/16	0.138	0.748	0.63
P.0430	1/4	0.150	0.820	0.72
P.0435	5/16	0.173	0.906	0.81
P.0440	3/8	0.165	1.110	0.92
P.0445	1/2	0.165	1.134	1.04

UNION EN T METRIQUE

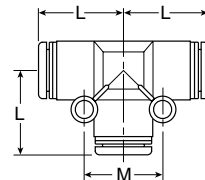

Part No.	Tube Size (mm)	Mounting Hole Dia. (mm)	L (mm)	M (mm)
P.1295	4	*	17.50	*
P.1305	6	18.80	16.00	3.50
P.1310	8	23.00	20.60	4.40
P.1315	10	28.50	23.40	4.20
P.1320	12	29.00	26.30	4.20

UNION COUDE 90° SAE

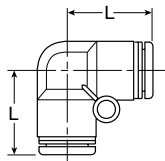

Part No.	Tube Size	Mounting Hole Dia.	L
P.0304	1/8	*	0.65
P.0305	5/32	*	0.65
P.0306	3/16	0.130	0.76
P.0310	1/4	0.130	0.76
P.0315	5/16	0.170	0.87
P.0320	3/8	0.157	1.13
P.0325	1/2	0.170	1.24

UNION COUDE 90° METRIQUE

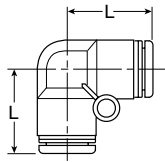

Part No.	Tube Size (mm)	Mounting Hole Dia. (mm)	L (mm)
P.1230	4	*	16.50
P.1235	6	3.50	19.30
P.1240	8	4.30	22.00
P.1245	10	4.00	28.70
P.1250	12	4.40	31.50

RACCORD COUDE MALE PIV SAE

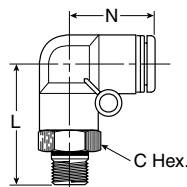

Part No.	Tube Size	UNF	Mounting Hole Dia.	C Hex.	L	N
P.0218	1/8	10-32	*	1/2	0.96	0.650
P.0235	5/32	10-32	*	1/2	0.96	0.650
P.0236	3/16	10-32	.138	9/16	1.09	0.760
P.0248	1/4	10-32	.138	9/16	1.09	0.760

RACCORD COUDE MALE PIV NPT

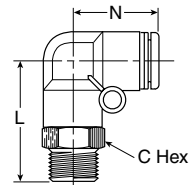

Part No.	Tube Size	NPT	Mounting Hole Dia.	C Hex.	L	N
P.0220	1/8	1/16	*	1/2	1.09	0.650
P.0225	1/8	1/8	*	1/2	1.10	0.650
P.0230	1/8	1/4	*	9/16	1.30	0.650
P.0236	5/32	1/16	*	1/2	1.09	0.650
P.0240	5/32	1/8	*	1/2	1.10	0.650
P.0245	5/32	1/4	*	9/16	1.30	0.650
P.0246	3/16	1/8	0.138	9/16	1.47	0.760
P.0247	3/16	1/4	0.138	9/16	1.43	0.760
P.0250	1/4	1/8	0.138	9/16	1.47	0.760
P.0255	1/4	1/4	0.138	9/16	1.43	0.760
P.0260	1/4	3/8	0.138	13/16	1.44	0.760
P.0265	5/16	1/8	0.169	5/8	1.26	0.866
P.0270	5/16	1/4	0.169	5/8	1.46	0.866
P.0271	5/16	3/8	0.169	13/16	1.50	0.866
P.0273	3/8	1/8	0.158	13/16	1.52	1.130
P.0275	3/8	1/4	0.158	13/16	1.72	1.130
P.0280	3/8	3/8	0.158	13/16	1.72	1.130
P.0285	3/8	1/2	0.158	15/16	1.94	1.130
P.0290	1/2	1/4	0.173	15/16	1.88	1.240
P.0295	1/2	3/8	0.173	15/16	1.89	1.240
P.0300	1/2	1/2	0.173	15/16	2.07	1.240

RACCORD COUDE MALE PIV BSPT

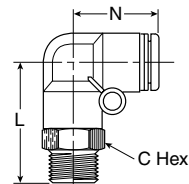

Part No.	Tube Size (mm)	BSPT	Mounting Hole Dia. (mm)	C Hex. (mm)	L (mm)	N (mm)
P.1600	4	1/8	*	12	24.9	16.5
P.1603	4	1/4	*	14	24.9	16.5
P.1604	4	3/8	*	17	27.9	16.5
P.1615	6	1/8	3.5	14	27.7	13.0
P.1620	6	1/4	3.5	14	29.7	13.0
P.1623	6	3/8	3.5	17	31.7	13.0
P.1625	8	1/8	4.3	17	29.0	22.0
P.1630	8	1/4	4.3	17	31.0	22.0
P.1632	8	3/8	4.3	17	33.0	22.0
P.1631	8	1/2	4.3	22	35.0	22.0
P.1635	10	1/4	4.0	21	36.5	28.7
P.1636	10	3/8	4.0	21	37.5	28.7
P.1634	10	1/2	4.0	22	40.5	28.7
P.1637	12	1/4	4.4	22	40.7	31.5
P.1638	12	3/8	4.4	22	41.7	31.5
P.1639	12	1/2	4.4	22	43.7	31.5

RACCORD COUDE MALE PIV BSPP

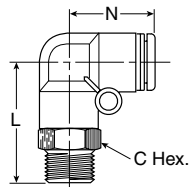

Part No.	Tube Size (mm)	BSPP	Mounting Hole Dia. (mm)	C Hex. (mm)	L (mm)	N (mm)
P.2600	4	1/8	*	12	26.9	16.5
P.2603	4	1/4	*	17	30.9	16.5
P.2604	4	3/8	*	21	32.9	16.5
P.2615	6	1/8	3.5	14	29.3	13.0
P.2620	6	1/4	3.5	17	33.3	13.0
P.2623	6	3/8	3.5	21	33.3	13.0
P.2625	8	1/8	4.3	17	30.0	22.0
P.2630	8	1/4	4.3	17	34.0	22.0
P.2632	8	3/8	4.3	21	34.0	22.0
P.2631	8	1/2	4.3	24	36.0	22.0
P.2635	10	1/4	4.0	21	40.5	28.7
P.2636	10	3/8	4.0	21	40.5	28.7
P.2634	10	1/2	4.0	24	42.5	28.7
P.2637	12	1/4	4.4	22	41.7	31.5
P.2638	12	3/8	4.4	22	41.7	31.5
P.2639	12	1/2	4.4	24	45.7	31.5

RACCORD COUDE FEM PIV NPT

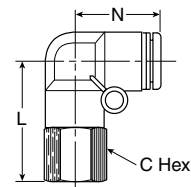

Part No.	Tube Size	NPT	Mounting Hole Dia.	C Hex.	L	N
P.2225	1/8	1/8	*	1/2	0.98	0.650
P.2230	1/8	1/4	*	5/8	1.14	0.650
P.2240	5/32	1/8	*	1/2	0.98	0.650
P.2245	5/32	1/4	*	5/8	1.14	0.650
P.2247	3/16	1/4	0.138	9/16	1.23	0.760
P.2250	1/4	1/8	0.138	9/16	1.08	0.760
P.2255	1/4	1/4	0.138	5/8	1.23	0.760
P.2260	1/4	3/8	0.138	13/16	1.27	0.760
P.2265	5/16	1/8	0.173	5/8	1.14	0.866
P.2270	5/16	1/4	0.173	5/8	1.30	0.866
P.2273	3/8	1/8	0.157	13/16	1.36	1.130
P.2275	3/8	1/4	0.157	13/16	1.52	1.130
P.2280	3/8	3/8	0.157	13/16	1.56	1.130
P.2285	3/8	1/2	0.157	15/16	1.70	1.130
P.2295	1/2	3/8	0.173	15/16	1.68	1.240
P.2300	1/2	1/2	1.730	15/16	2.27	1.240

RACCORD COUDE FEM PIV BSPT

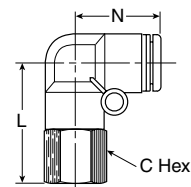

Part No.	Tube Size (mm)	BSPT	Mounting Hole Dia. (mm)	C Hex. (mm)	L (mm)	N (mm)
P.3600	4	1/8	*	12	24.5	16.5
P.3603	4	1/4	*	17	25.9	16.5
P.3604	4	3/8	*	21	26.4	16.5
P.3615	6	1/8	3.5	14	28.8	19.3
P.3620	6	1/4	3.5	17	28.8	19.3
P.3623	6	3/8	3.5	21	28.8	19.3
P.3625	8	1/8	4.3	17	31.0	22.0
P.3630	8	1/4	4.3	17	31.0	22.0
P.3632	8	3/8	4.3	21	32.0	22.0
P.3631	8	1/2	4.3	22	32.0	22.0
P.3635	10	1/4	4.0	21	36.5	28.7
P.3636	10	3/8	4.0	21	37.5	28.7
P.3634	10	1/2	4.0	24	37.5	28.7
P.3637	12	1/4	4.4	22	40.7	31.5
P.3638	12	3/8	4.4	22	40.7	31.5
P.3639	12	1/2	4.4	24	51.2	31.5

RACCORD COUDE MALE PIV METR

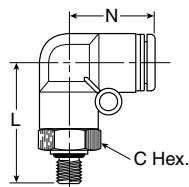

Part No.	Tube Size (mm)	Metric	Mounting Hole Dia. (mm)	C Hex. (mm)	L (mm)	N (mm)
P.1595	4	M5	•	12	26.9	16.5
P.1596	4	M6	•	12	26.9	16.5
P.1613	6	M5	3.5	14	29.3	19.3
P.1614	6	M6	3.5	14	29.3	19.3

RACCORD COUDE FEM PIV METR.

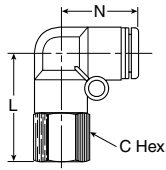

Part No.	Tube Size (mm)	Metric	Mounting Hole Dia. (mm)	C Hex. (mm)	L (mm)	N (mm)
P.3595	4	M5	*	12	23.0	16.5
P.3596	4	M6	*	12	23.0	16.5
P.3613	6	M5	3.5	14	25.3	19.3
P.3614	6	M6	3.5	14	25.3	19.3

RACCORD EN T PIV SAE 10-32

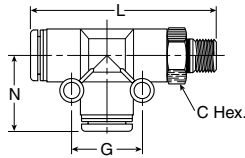

Part No.	Tube Size	UNF	Mounting Hole Dia.	C Hex.	L	N	G
P.0452	5/32	10-32	*	1/2	1.71	0.689	*
P.0453	1/4	10-32	0.138	9/16	1.81	0.740	0.63

RACCORD EN T PIV NPT

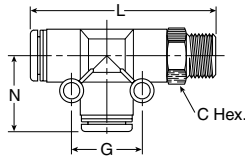

Part No.	Tube Size	NPT	Mounting Hole Dia.	C Hex.	L	N	G
P.0454	1/8	1/16	*	1/2	1.86	0.689	*
P.0455	1/8	1/8	*	1/2	1.86	0.689	*
P.0456	1/8	1/4	*	9/16	2.06	0.689	*
P.0464	5/32	1/16	*	1/2	1.85	0.689	*
P.0465	5/32	1/8	*	1/2	1.85	0.689	*
P.0466	5/32	1/4	*	9/16	2.05	0.689	*
P.0470	3/16	1/8	0.138	9/16	1.94	0.740	0.630
P.0471	3/16	1/4	0.138	9/16	2.15	0.740	0.630
P.0475	1/4	1/8	0.138	9/16	1.94	0.740	0.630
P.0480	1/4	1/4	0.138	9/16	2.15	0.740	0.630
P.0485	1/4	3/8	0.138	13/16	2.19	0.740	0.630
P.0490	5/16	1/8	0.173	5/8	2.21	0.906	0.811
P.0495	5/16	1/4	0.173	5/8	2.41	0.906	0.811
P.0496	5/16	3/8	0.173	13/16	2.46	0.906	0.811
P.0500	3/8	1/8	0.165	13/16	2.61	1.122	0.921
P.0505	3/8	1/4	0.165	13/16	2.80	1.122	0.921
P.0510	3/8	3/8	0.165	13/16	2.81	1.122	0.921
P.0515	3/8	1/2	0.165	15/16	3.03	1.122	0.921
P.0520	1/2	1/4	0.165	15/16	2.89	1.142	1.035
P.0525	1/2	3/8	0.165	15/16	2.90	1.142	1.035
P.0530	1/2	1/2	0.165	15/16	3.12	1.142	1.035

RACCORD EN T PIV BSPT

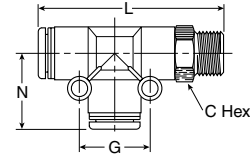

Part No.	Tube Size (mm)	BSPT	Mounting Hole Dia. (mm)	C Hex. (mm)	L (mm)	N (mm)	G (mm)
P.3445	4	1/8	*	12	43.9	17.5	*
P.3446	4	1/4	*	14	45.9	17.5	*
P.3447	4	3/8	*	17	47.9	17.5	*
P.3460	6	1/8	3.5	14	46.3	18.8	16.0
P.3462	6	1/4	3.5	14	48.3	18.8	16.0
P.3465	6	3/8	3.5	17	50.3	18.8	16.0
P.3470	8	1/8	4.4	17	53.2	23.0	20.6
P.3475	8	1/4	4.4	17	55.2	23.0	20.6
P.3476	8	3/8	4.4	17	57.2	23.0	20.6
P.3477	8	1/2	4.4	22	59.2	23.0	20.6
P.3480	10	1/4	4.2	21	64.2	28.5	23.4
P.3481	10	3/8	4.2	21	65.2	28.5	23.4
P.3482	10	1/2	4.2	22	68.2	28.5	23.4
P.3483	12	1/4	4.2	22	67.0	29.0	26.3
P.3484	12	3/8	4.2	22	68.0	29.0	26.3
P.3485	12	1/2	4.2	22	70.0	29.0	26.3

RACCORD EN T PIV METR.

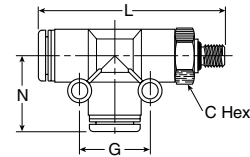

Part No.	Tube Size (mm)	Metric	Mounting Hole Dia. (mm)	C Hex. (mm)	L (mm)	N (mm)	G (mm)
P.3495	4	M5	*	12	46.0	17.5	*
P.3496	4	M6	*	12	46.0	17.5	*
P.3513	6	M5	3.5	14	48.3	18.8	16.0
P.3514	6	M6	3.5	14	48.3	18.8	16.0

RACCORD COUDE MALE PIV SAE

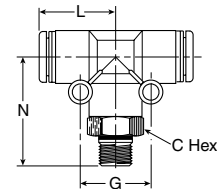

Part No.	Tube Size	UNF	Mounting Hole Dia.	C Hex.	L	N	G
P.3618	1/8	10-32	*	1/2	1.32	1.00	*
P.3635	5/32	10-32	*	1/2	1.32	1.00	*
P.3648	1/4	10-32	0.138	9/16	1.38	1.04	0.63

RACCORD EN T PIV NPT

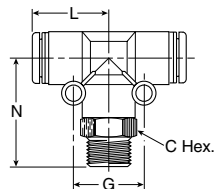

Part No.	Tube Size	NPT	Mounting Hole Dia.	C Hex.	L	N	G
P.0335	1/8	1/8	*	1/2	1.36	1.14	*
P.0336	1/8	1/4	*	9/16	1.56	1.34	*
P.0345	5/32	1/8	*	1/2	1.36	1.14	*
P.0351	3/16	1/8	0.138	9/16	1.44	1.17	0.630
P.0352	3/16	1/4	0.138	9/16	1.62	1.38	0.630
P.0360	1/4	1/8	0.138	9/16	1.44	1.17	0.630
P.0365	1/4	1/4	0.138	9/16	1.62	1.38	0.630
P.0370	1/4	3/8	0.138	13/16	1.64	1.42	0.630
P.0375	5/16	1/8	0.173	5/8	1.61	1.31	0.811
P.0380	5/16	1/4	0.173	5/8	1.82	1.51	0.811
P.0385	5/16	3/8	0.173	13/16	1.81	1.56	0.811
P.0389	3/8	1/8	0.165	13/16	1.88	1.50	0.921
P.0390	3/8	1/4	0.165	13/16	2.04	1.70	0.921
P.0395	3/8	3/8	0.165	13/16	2.04	1.71	0.921
P.0400	3/8	1/2	0.165	15/16	2.27	1.93	0.921
P.0405	1/2	1/4	0.165	15/16	2.15	1.74	1.035
P.0410	1/2	3/8	0.165	15/16	2.16	1.74	1.035
P.0415	1/2	1/2	0.165	15/16	2.36	1.96	1.035

RACCORD EN T PIV BSPT

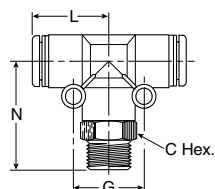

Part No.	Tube Size (mm)	BSPT	Mounting Hole Dia. (mm)	C Hex. (mm)	L (mm)	N (mm)	G (mm)
P.0645	4	1/8	*	12	35.0	26.0	*
P.0646	4	1/4	*	14	35.0	28.0	*
P.0647	4	3/8	*	17	35.0	30.0	*
P.0660	6	1/8	3.5	14	37.6	26.8	16.0
P.0662	6	1/4	3.5	14	37.6	28.8	16.0
P.0665	6	3/8	3.5	17	37.6	30.8	16.0
P.0670	8	1/8	4.4	17	46.0	30.2	20.6
P.0675	8	1/4	4.4	17	46	32.2	20.6
P.0676	8	3/8	4.4	17	46	34.2	20.6
P.0677	8	1/2	4.4	22	46	36.2	20.6
P.0680	10	1/4	4.2	21	57	36.2	23.4
P.0681	10	3/8	4.2	21	57	37.2	23.4
P.0682	10	1/2	4.2	22	57	40.2	23.4
P.0683	12	1/4	4.2	22	58	38.0	26.3
P.0684	12	3/8	4.2	22	58	39.0	26.3
P.0685	12	1/2	4.2	22	58	41.0	26.3

RACCORD EN T PIV METRIQUE

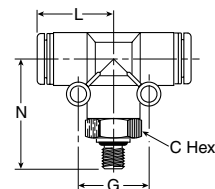

Part No.	Tube Size (mm)	Metric	Mounting Hole Dia. (mm)	C Hex. (mm)	L (mm)	N (mm)	G (mm)
P.0640	4	M5	*	12	35.0	28.0	*
P.0641	4	M6	*	12	35.0	28.0	*
P.0642	6	M5	3.5	14	37.6	28.8	16.0
P.0643	6	M6	3.5	14	37.6	28.8	16.0

UNION EN Y SAE

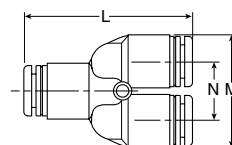

Part No.	Tube Size	Mounting Hole Dia.	L	M	N
P.0535	1/8	0.118	1.358	0.421	0.846
P.0540	5/32	0.118	1.358	0.421	0.846
P.0541	3/16	0.129	1.417	0.531	1.063
P.0545	1/4	0.150	1.450	0.561	1.100
P.0550	5/16	0.150	1.693	0.591	1.201
P.0552	3/8	0.165	1.969	0.728	1.457
P.0554	1/2	0.173	2.256	0.807	1.646

UNION EN Y METRIQUE

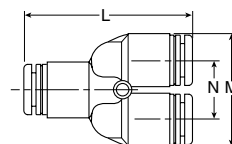

Part No.	Tube Size (mm)	Mounting Hole Dia. (mm)	L (mm)	M (mm)	N (mm)
P.1540	4	3.0	34.5	21.5	10.7
P.1545	6	3.4	36.0	27.0	13.5
P.1550	8	3.8	43.0	30.5	15.0
P.1552	10	4.2	50.8	37.0	18.5
P.1554	12	4.4	57.8	41.5	20.5

RACCORD EN Y NPT

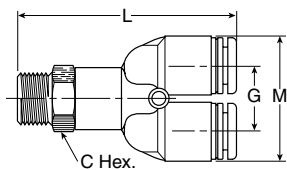

Part No.	Tube Size	NPT	Mounting Hole Dia.	C Hex.	L	G	M
P.0700	1/8	1/8	0.118	1/2	1.84	0.433	0.854
P.0701	1/8	1/4	0.118	9/16	2.04	0.433	0.854
P.0705	3/16	1/8	0.134	9/16	1.89	0.531	1.063
P.0706	3/16	1/4	0.134	9/16	2.09	0.531	1.063
P.0710	5/32	1/8	0.118	1/2	1.83	0.433	0.854
P.0711	5/32	1/4	0.118	9/16	2.03	0.433	0.854
P.0720	1/4	1/8	0.134	9/16	1.89	0.531	1.063
P.0725	1/4	1/4	0.134	9/16	2.09	0.531	1.063
P.0730	1/4	3/8	0.134	13/16	2.10	0.531	1.063
P.0735	5/16	1/8	0.150	5/8	2.07	0.590	1.201
P.0740	5/16	1/4	0.150	5/8	2.28	0.590	1.201
P.0745	3/8	1/8	0.165	13/16	2.36	0.728	1.457
P.0750	3/8	1/4	0.165	13/16	2.57	0.728	1.457
P.0755	3/8	3/8	0.165	13/16	2.57	0.728	1.457
P.0760	3/8	1/2	0.173	15/16	2.79	0.728	1.457
P.0765	1/2	1/4	0.173	15/16	2.91	0.807	1.654
P.0770	1/2	3/8	0.173	15/16	2.92	0.807	1.654
P.0775	1/2	1/2	0.173	15/16	3.11	0.807	1.654

RACCORD EN Y METRIQUE

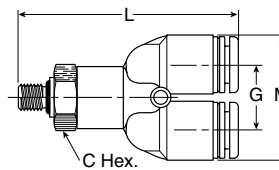

Part No.	Tube Size (mm)	Metric	Mounting Hole Dia. (mm)	C Hex. (mm)	L (mm)	G (mm)	M (mm)
P.1705	4	M5	3.0	12	43.4	11.0	21.5
P.1706	4	M6	3.0	12	43.4	11.0	21.5
P.1707	4	M5	3.4	14	44.2	13.5	27.0
P.1708	6	M6	3.4	14	44.2	13.5	27.0

RACCORD EN Y BSPT

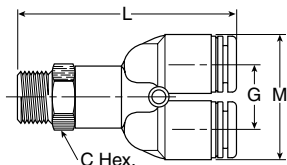

Part No.	Tube Size (mm)	BSPT	Mounting Hole Dia. (mm)	C Hex. (mm)	L (mm)	G (mm)	M (mm)
P.1710	4	1/8	3.0	12	43.4	11.0	21.5
P.1715	4	1/4	3.0	14	45.4	11.0	21.5
P.1716	4	3/8	3.0	17	47.4	11.0	21.5
P.1720	6	1/8	3.4	14	44.2	13.5	27.0
P.1725	6	1/4	3.4	14	46.2	13.5	27.0
P.1726	6	3/8	3.4	17	48.2	13.5	27.0
P.1730	8	1/8	3.8	17	50.0	15.0	30.5
P.1740	8	1/4	3.8	17	52.0	15.0	30.5
P.1745	8	3/8	3.8	17	54.0	15.0	30.5
P.1750	8	1/2	3.8	22	56.0	15.0	30.5
P.1755	10	1/4	4.2	21	58.3	18.5	37.0
P.1756	10	3/8	4.2	21	59.3	18.5	37.0
P.1757	10	1/2	4.2	22	62.3	18.5	37.0
P.1760	12	1/4	4.4	22	66.8	20.5	41.5
P.1761	12	3/8	4.4	22	67.8	20.5	41.5
P.1762	12	1/2	4.4	22	69.8	20.5	41.5

UNION SAE

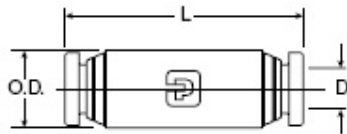

Part No.	Tube Size	O.D.	L	Flow Dia. D
HP.0190	1/8	0.375	1.40	0.094
HP.0196	3/16	0.437	1.41	0.156
HP.0195	5/32	0.375	1.41	0.125
HP.0200	1/4	0.500	1.43	0.188
HP.0205	5/16	0.562	1.65	0.250
HP.0210	3/8	0.625	1.66	0.312
HP.0215	1/2	0.750	1.82	0.375

UNION PASSE-CLOISON

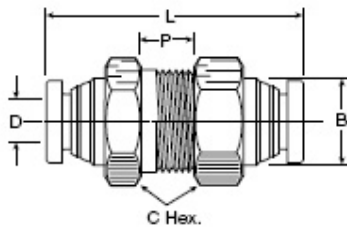

Part No.	Tube Size	B	C Hex.	P Max.	L	D
HP.0649	1/8	7/16	9/16	0.39	1.40	0.094
HP.0650	5/32	7/16	9/16	0.39	1.41	0.125
HP.0655	1/4	9/16	11/16	0.29	1.43	0.188
HP.0660	5/16	5/8	3/4	0.60	1.65	0.250
HP.0665	3/8	3/4	7/8	0.54	1.66	0.312
HP.0670	1/2	7/8	1	0.66	2.04	0.375

UNION PASSE-CLOISON METRIQUE

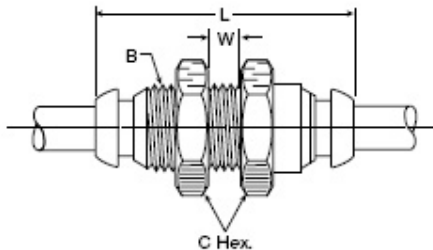

Part No.	Tube Size (mm)	B Thread (mm)	C Hex. (mm)	L (mm)	W (mm)	Bulkhead Hole Dia. (mm)
HP.0560	4	M11x0.75	16	33	6	11
HP.0570	6	M13x1	19	35	6	13
HP.0575	8	M16x1.25	22	36	6	16
HP.0580	10	M18x1	22	43	8	18
HP.0585	12	M23x1.5	27	46	10	23
HP.0590	14	M24x1.5	30	52	10	24

RACCORD FEMELLE NPT

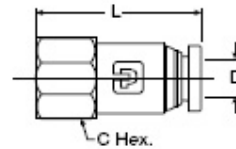

Part No.	Tube Size	B Thread (NPTF)	L	Flow Dia. D
HP.0800	1/8	1/8	1.17	0.094
HP.0801	3/16	1/8	1.13	0.156
HP.0802	5/32	1/8	1.17	0.125
HP.0803	5/32	1/4	1.38	0.125
HP.0804	1/4	1/8	1.17	0.188
HP.0805	1/4	1/4	1.38	0.188
HP.0806	5/16	1/8	1.25	0.250
HP.0807	5/16	1/4	1.45	0.250
HP.0809	3/8	1/4	1.46	0.312
HP.0810	3/8	3/8	1.51	0.312

RACCORD FEMELLE BSPP

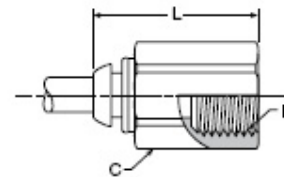

Part No.	Tube Size (mm)	Thread (BSPP)	C Hex. (mm)	L (mm)
HP.0203	4	1/8	14	26.0
HP.0205	6	1/8	14	27.5
HP.0210	6	1/4	17	33.0
HP.0215	8	1/8	17	29.0
HP.0212	8	1/4	17	33.0

RACCORD PASSE-CLOISON NPTF

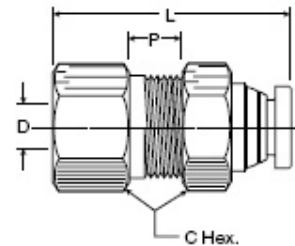

Part No.	Tube Size	Pipe Thread (NPTF)	C Hex.	P Max.	L	Flow Dia. D	Bulkhead Hole Dia. (mm)
HP.0630	5/32	1/4	11/16	0.19	1.39	0.125	1/2
HP.0635	1/4	1/4	11/16	0.24	1.35	0.188	9-16
HP.0640	3/8	3/8	1	0.22	1.47	0.312	7/8
HP.0641	1/2	3/8	1-1/4	0.35	1.56	0.344	1

RACCORD PASSE-CLOISON BSPP

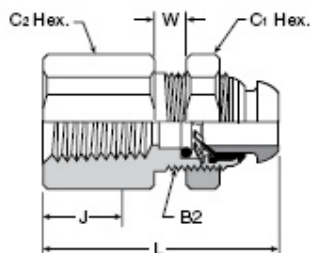

Part No.	Tube Size (mm)	Thread (BSPP)	B2	C1 Hex. (mm)	C2 Hex. (mm)	J (mm)	L (mm)	W (mm)
HP.0203	4	G1/8	M1x0.75	14	14	8	25.0	6
HP.0205	6	G1/8	M1.3x1	17	17	8	25.0	6
HP.0210	6	G1/4	M1.3x1	17	19	12	29.5	6
HP.0215	8	G1/8	M1.5x1.25	19	17	8	25.0	6
HP.0212	8	G1/4	M1.5x1.25	19	19	12	30.0	6
HP.0217	10	G3/8	M1.8x1	22	22	12	34.0	8
HP.0218	12	G3/8	M2.3x1.25	27	24	12	35.0	10
HP.0219	12	G1/2	M2.3x1.25	27	27	14	40.0	10

RACCORD MALE NPT

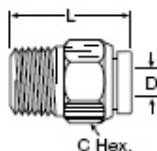

Part No.	Tube Size	Pipe Thread	C Hex.	L	Flow Dia. D
HP.0100	1/8	1/16	3/8	0.79	0.094
HP.0105	1/8	1/8	7/16	0.79	0.094
HP.0106	1/8	1/4	9/16	1.02	0.094
HP.0127	3/16	1/8	7/16	0.85	0.141
HP.0128	3/16	1/4	9/16	1.01	0.156
HP.0116	5/32	1/16		0.88	0.940
HP.0120	5/32	1/8	7/16	0.80	0.125
HP.0125	5/32	1/4	9/16	1.03	0.125
HP.0129	1/4	1/16	1/2	1.07	0.141
HP.0130	1/4	1/8	1/2	0.89	0.188
HP.0135	1/4	1/4	9/16	1.00	0.188
HP.0140	1/4	3/8	3/4	1.04	0.188
HP.0145	5-16	1/8	9/16	1.18	0.234
HP.0150	5-16	1/4	9/16	1.04	0.250
HP.0155	5/16	3/8	11/16	1.04	0.250
HP.0159	3/8	1/8	5/8	1.21	0.234
HP.0160	3/8	1/4	5/8	1.08	0.312
HP.0165	3/8	3/8	11/16	1.02	0.312
HP.0170	3/8	1/2	7/8	1.289	0.312
HP.0175	1/2	1/4	13/16	1.44	0.344
HP.0180	1/2	3/8	13/16	1.24	0.344
HP.0185	1/2	1/2	7/8	1.35	0.375
HP.0114	5/32	1/4-28	7/16	0.88	0.093

RACCORD MALE SAE

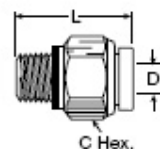

Part No.	Tube Size	Pipe Thread (NPTF)	C Hex.	L	Flow Dia. D
HP.0101	1/8	10x32	3/8	0.92	0.094
HP.0115	5/32	10x32			
HP.0128	1/4	10x32	1/2	0.96	0.094

RACCORD MALE BSPP

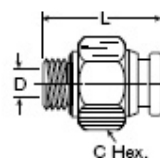

Part No.	Tube Size	Pipe Thread BSPP	C Hex.	L	Flow Dia. D
HP.0190	3/16	1/8-28	11/16	0.96	0.156
HP.0191	3/16	1/4-19	3/4	0.97	0.156
HP.0192	1/4	1/8-28	11/16	1.13	0.188
HP.0193	1/4	1/4-19	3/4	1.13	0.188
HP.0194	1/4	3/8-19	7/8	1.13	0.188
HP.0195	3/8	1/4-19	3/4	1.26	0.256
HP.0196	3/8	3/8-19	7/8	1.26	0.312
HP.0197	3/8	1/2-14	1-1/16	1.26	0.312
HP.0198	1/2	3/8-19	7/8	1.41	0.452
HP.0199	1/2	1/2-14	1-1/16	1.37	0.452

UNION EN T SAE

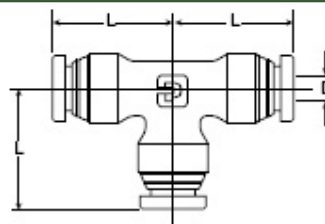

Part No.	Tube Size	L	Flow Dia. D
HP.0420	1/8	0.74	0.094
HP.0425	5/32	0.77	0.125
HP.0426	3/16	0.82	0.156
HP.0430	1/4	0.85	0.188
HP.0435	5/16	0.97	0.250
HP.0440	3/8	1.01	0.250
HP.0445	1/2	1.15	0.375

UNION COUDE 90° SAE

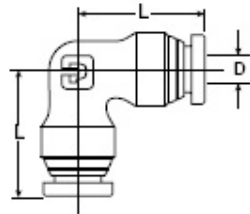

Part No.	Tube Size	L	Flow Dia. D
HP.0304	1/8	0.74	0.094
HP.0305	5/32	0.77	0.125
HP.0306	3/16	0.82	0.156
HP.0310	1/4	0.85	0.188
HP.0315	5/16	0.97	0.250
HP.0320	3/8	1.01	0.312
HP.0325	1/2	1.15	0.375

RACCORD COUDE MALE NPT

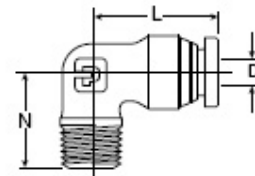

Part No.	Tube Size	Pipe Thread (NPTF)	L	N	Flow Dia. D
HP.4225	1/8	1/8	0.74	0.67	0.094
HP.4240	5/32	1/8	0.77	0.67	0.125
HP.4245	5/32	1/4	0.77	0.87	0.125
HP.4250	1/4	1/8	0.85	0.67	0.188
HP.4255	1/4	1/4	0.85	0.87	0.188
HP.4265	5/16	1/8	0.97	0.75	0.250
HP.4270	5/16	1/4	0.97	0.94	0.250
HP.4275	3/8	1/4	1.01	0.94	0.312
HP.4280	3/8	3/8	1.01	1.01	0.312
HP.4285	3/8	1/2	1.01	1.27	0.312
HP.4295	1/2	3/8	1.15	1.00	0.375
HP.4300	1/2	1/2	1.15	1.27	0.375
HP.4239	5/32	1/4-28	0.60	0.48	0.090

RACCORD COUDE MALE PIV NPT

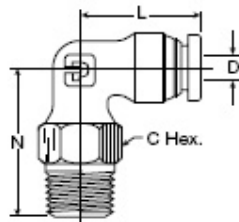

Part No.	Tube Size	Pipe Thread (NPTF)	C Hex.	L	N	Flow Dia. D
HP.0225	1/8	1/8	7/16	0.74	0.92	0.094
HP.0218	1/8	10-32	3/8	0.74	0.74	0.094
HP.0230	1/8	1/4	9/16	0.74	1.10	0.094
HP.0246	3/16	1/8	7/16	0.82	0.92	0.156
HP.0240	5/32	1/8	7/16	0.77	0.92	0.125
HP.0245	5/32	1/4	9/16	0.77	1.10	0.125
HP.0235	5/32	10-32	3/8	0.85	0.74	0.188
HP.0250	1/4	1/8	7/16	0.85	0.92	0.188
HP.0255	1/4	1/4	9/16	0.85	1.10	0.188
HP.0260	1/4	3/8	11/16	0.85	1.19	0.188
HP.0248	1/4	10-32	3/8	0.85	0.74	0.188
HP.0265	5/16	1/8	9/16	0.97	1.02	0.250
HP.0270	5/16	1/4	9/16	0.97	1.24	0.250
HP.0273	3/8	1/8	9/16	1.01	1.02	0.312
HP.0275	3/8	1/4	9/16	1.01	1.24	0.312
HP.0280	3/8	3/8	11/16	1.01	1.24	0.312
HP.0285	3/8	1/2	7/8	1.01	1.48	0.312
HP.0290	1/2	1/4	9/16	1.15	1.28	0.375
HP.0295	1/2	3/8	11/16	1.15	1.31	0.375
HP.0300	1/2	1/2	7/8	1.15	1.52	0.375

RACCORD EN T PIV NPT

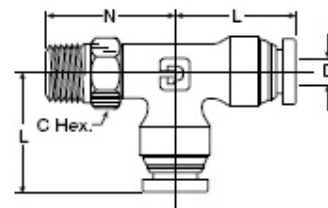

Part No.	Tube Size	Pipe Thread (NPTF)	C Hex.	L	N	Flow Dia. D
HP.0455	1/8	1/8	7/16	0.74	0.92	0.094
HP.0465	5/32	1/8	7/16	0.77	0.92	0.125
HP.0475	1/4	1/8	7/16	0.85	0.92	0.188
HP.0480	1/4	1/4	9/16	0.85	1.10	0.188
HP.0485	1/4	3/8	11/16	0.85	1.24	0.188
HP.0490	5/16	1/8	9/16	0.97	1.02	0.250
HP.0495	5/16	1/4	9/16	0.97	1.24	0.250
HP.0505	3/8	1/4	9/16	1.01	1.24	0.250
HP.0510	3/8	3/8	11/16	1.01	1.24	0.250
HP.0525	1/2	3/8	11/16	1.15	1.31	0.375
HP.0530	1/2	1/2	7/8	1.15	1.52	0.375

RACCORD EN T PIV NPT

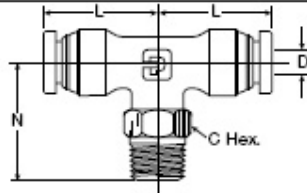

Part No.	Tube Size	Pipe Thread NPT	C Hex.	L	N	Flow Dia. D
HP.0335	1/8	1/8	7/16	0.74	0.92	0.094
HP.0351	3/16	1/8	7/16	0.82	0.92	0.156
HP.0345	5/32	1/8	7/16	0.77	0.92	0.125
HP.0360	1/4	1/8	7/16	0.85	0.92	0.188
HP.0365	1/4	1/4	9/16	0.85	1.10	0.188
HP.0370	1/4	3/8	11/16	0.85	1.10	0.188
HP.0375	5/16	1/8	9/16	0.97	1.02	0.250
HP.0380	5/16	1/4	9/16	0.97	1.24	0.250
HP.0390	3/8	1/4	9/16	1.01	1.24	0.250
HP.0395	3/8	3/8	11/16	1.01	1.24	0.250
HP.0405	1/2	1/4	9/16	1.15	1.30	0.375
HP.0410	1/2	3/8	11/16	1.15	1.31	0.375
HP.0415	1/2	1/2	7/8	1.15	1.52	0.375

UNION PASSE-CLOISON

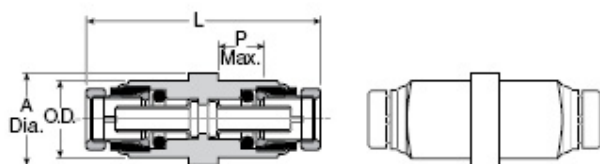

Part No.	Tube Size	O.D.	Rec. Hole Size	P Max.	L	A Dia.
62PMTBHR-4	1/4	0.500	0.512	0.26	1.53	0.625
62PMTBHR-6	3/8	0.750	0.762	0.36	1.92	0.875
62PMTBHR-8	1/2	0.875	0.897	0.43	2.15	1.000
62PMTBHR-10	5/8	1.000	1.012	0.62	2.54	1.250

BARRURE / UNION PASSE-CLOISON

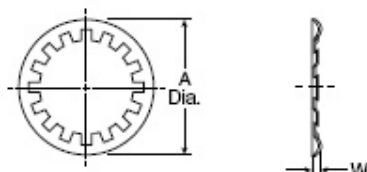

Part No.	Tube Size	Bulkhead Union O.D.	A Dia.	W
ERHD-50	1/4	0.500	0.83	0.05
ERHD-75	3/8	0.750	1.08	0.05
ERHD-87	1/2	0.875	1.20	0.05
ERHD-100	5/8	1.000	1.33	0.05

*Material Carbon Spring Steel

UNION

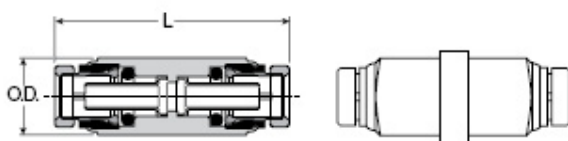

Part No.	Tube Size	L	O.D.
62PMT-4	1/4	1.48	0.50
62PMT-4-2	1/4 - 1/8	1.48	0.50
62PMT-6	3/8	1.87	0.75
62PMT-6-4	3/8 - 1/4	1.68	0.75
62PMT-8	1/2	2.03	0.88
62PMT-10	5/8	2.42	1.00

JOINT / UNION PASSE-CLOISON

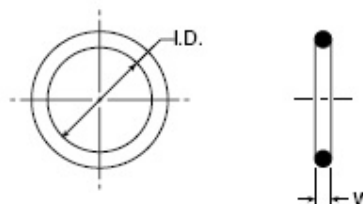

Part No.	Tube Size	Bulkhead Union O.D.	A Dia.	W
ES-50	1/4	0.500	0.489	0.07
ES-75	3/8	0.750	0.739	0.07
ES-87	1/2	0.875	0.864	0.07

*Material is Nitrite (Buna N), 70 Durometer

UNION



Part No.	Tube Size	L	O.D.
62PM-2	1/8	1.60	0.406
62PM-5/32	5/32	1.60	0.406
62PM-3	3/16	1.35	0.440

*Material is Nitrite (Buna N), 70 Durometer

UNION PASSE-CLOISON

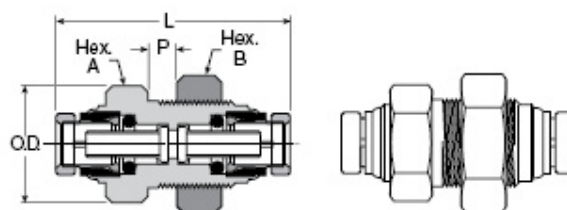

Part No.	Tube Size	O.D.	L	P Max.	A Hex.	B Hex.	Bulkhead Hole Dia.
62PMTBH-4	1/4	0.56	1.69	0.25	11/16	3/4	9/16
62PMTBH-6	3/8	0.88	1.93	0.44	1-1/16	1-1/16	7/8
62PMTBH-8	1/2	1.00	2.02	0.58	1-1/4	1-1/4	1
62PMTBH-10	5/8	1.12	2.92	0.81	1-1/4	1-3/8	1-1/8

RACCORD FEMELLE NPT

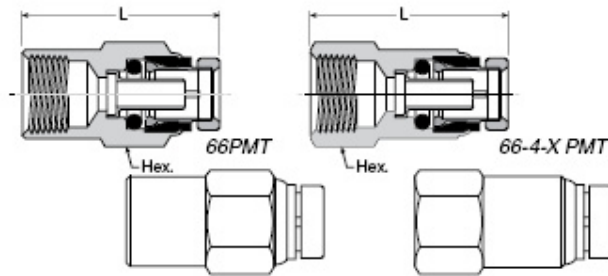

Part No.	Tube Size	Pipe Thread	L	Hex.
66PMT-4-2	1/4	1/8	1.22	9/16
66PMT-4-4	1/4	1/4	1.43	11/16
66PMT-6-2	3/8	1/8	1.37	3/4
66PMT-6-4	3/8	1/4	1.58	3/4
66PMT-6-6	3/8	3/8	1.62	13/16
66PMT-8-4	1/2	1/4	1.69	7/8
66PMT-8-6	1/2	3/8	1.68	7/8
66PMT-8-8	1/2	1/2	1.91	1

† U.S. Patent No. 5,683,120

RACCORD MALE NPT

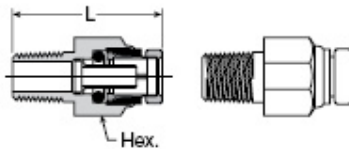

Part No.	Tube Size	Pipe Thread	L	Hex.
68PMT-4-2	1/4	1/8	1.06	1/2
68PMT-4-4	1/4	1/4	1.19	9/16
68PMT-4-6	1/4	3/8	1.27	3/4
68PMT-6-2	3/8	1/8	1.37	3/4
68PMT-6-4	3/8	1/4	1.43	3/4
68PMT-6-6	3/8	3/8	1.33	3/4
68PMT-6-8	3/8	1/2	1.38	7/8
68PMT-8-4	1/2	1/4	1.72	7/8
68PMT-8-6	1/2	3/8	1.52	7/8
68PMT-8-8	1/2	1/2	1.44	7/8
68PMT-10-6	5/8	3/8	1.88	1
68PMT-10-8	5/8	1/2	1.88	1
68PMT-12-8	3/4	1/2	2.03	1-3/16
68PMT-12-12	3/4	3/4	2.03	1-1/8

RACCORD PASSE-CLOISON NPT

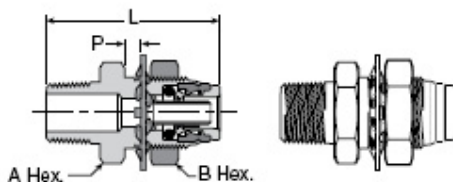

Part No.	Tube Size	Pipe Thread	L	P Max.	A Hex.	B Hex.	Bulkhead Hole Dia.
68PMTBH-6-8	3/8	1/2	2.37	0.33	1-1/4	1-1/4	1
68PMTBH-8-8	1/2	1/2	2.38	0.33	1-1/4	1-1/4	1

RACCORD PASSE-CLOISON FEM NPT

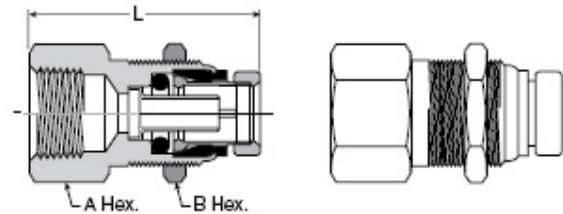

Part No.	Tube Size	Pipe Thread	L	A Hex.	B Hex.	Bulkhead Hole Dia.
66PMTBH-4-4	1/4	1/4	1.62	11/16	3/4	9/16
66PMTBH-6-6	3/8	3/8	1.87	1.06	1.06	7/8
66PMTBH-8-8	1/2	1/2	2.02	1-1/4	1-1/4	1

RACCORD MALE NPT

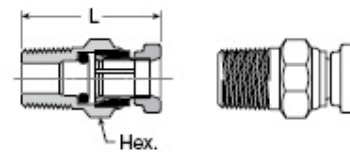

Part No.	Tube Size	Pipe Thread	L	Hex.
68PM-2-1	1/8	1/16	0.93	3/8
68PM-2-2	1/8	1/8	0.88	7/16
68PM-5/32-1	5/32	1/16	0.95	3/8
68PM-5/32-2	5/32	1/8	0.74	7/16
68PM-5/32-4	5/32	1/4	0.99	9/16
68PM-3-1	3/16	1/16	0.95	7/16
68PM-3-2	3/16	1/8	0.92	7/16
68PM-3-4	3/16	1/4	1.10	9/16

RACCORD MALE MÉTRIQUE

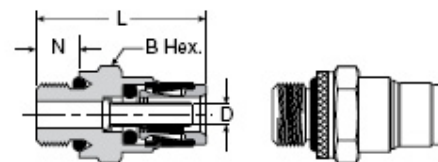

Part No.	Tube Size	Metric Thread	L	B Hex.	N
68PMT-4-M12	1/4	M12x1.5	1.19	11/16	0.29
68PMT-4-M16	1/4	M16x1.5	1.29	7/8	0.39
68PMT-6-M12	3/8	M12x1.5	1.40	3/4	0.29
68PMT-6-M16	3/8	M16x1.5	1.35	7/8	0.39
68PMT-6-M22	3/8	M22x1.5	1.23	1-1/16	0.40
68PMT-8-M12	1/2	M12x1.5	1.45	7/8	0.29
68PMT-8-M16	1/2	M16x1.5	1.52	7/8	0.39
68PMT-8-M22	1/2	M22x1.5	1.31	1-1/16	0.37
68PMT-10-M16	5/8	M16x1.5	1.78	1	0.39

UNION EN T

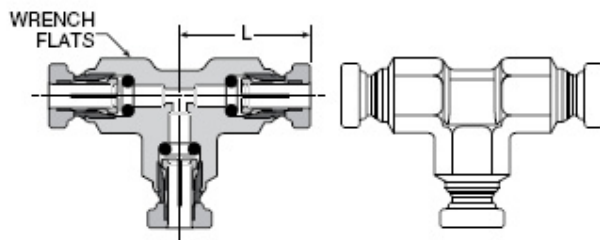

Part No.	Tube Size	L	Wrench Flats
164PM-2	1/8	0.81	0.42
164PM-5/32	5-32	0.71	0.42

UNION EN T

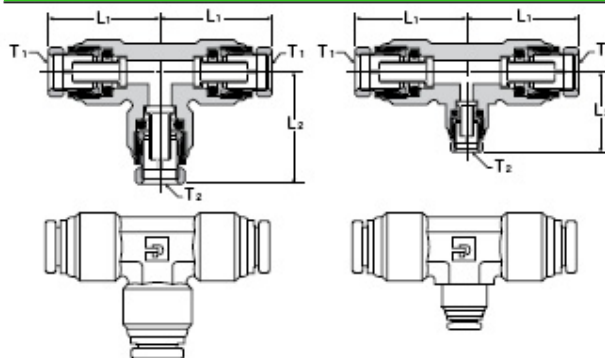

Part No.	Tube 1 Size	Tube 2 Size	L1	L2
164PMT-4	1/4	1/4	0.85	0.85
164PMT-6	3/8	3/8	1.21	1.21
164PMT-6-6-5/32	3/8	5/32	1.22	0.85
164PMT-6-6-4	3/8	1/4	1.21	0.93
164PMT-8	1/2	1/2	1.27	1.27
164PMT-10	5/8	5/8	1.63	1.62

UNION EN COUDE

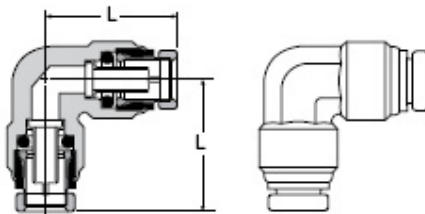

Part No.	Tube Size	L
165PMT-4	1/4	0.85
165PMT-6	3/8	1.11
165PMT-8	1/2	1.24
165PMT-10	5/8	1.57

UNION COUDE PASSE-CLOISON

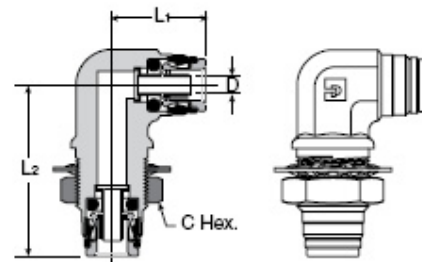

Part No.	Tube Size	L1	L2	C Hex.	Flow Dia. D	Bulkhead Hole Dia.
165PMTBH-6-8	1/2	1.29	2.45	1-1/4	0.34	1

RACCORD EN COUDE RIGIDE NPT

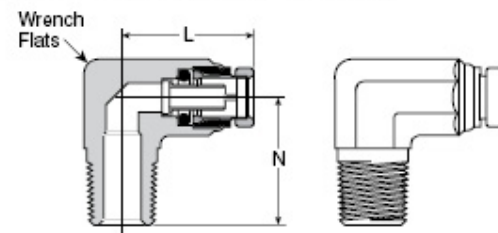

Part No.	Tube Size	Pipe Thread	L	N	Wrench Flats
169PMNS-2-2	1/8	1/8	0.86	0.68	3/8
169PMNS-5/3-2	5-32	1/8	0.88	0.68	3/8
169PMNS-3-2	3/16	1/8	0.75	0.67	3/8
169PMNS-3-4	3/16	1/4	0.74	0.93	1/2

RACCORD EN COUDE PIV NPT

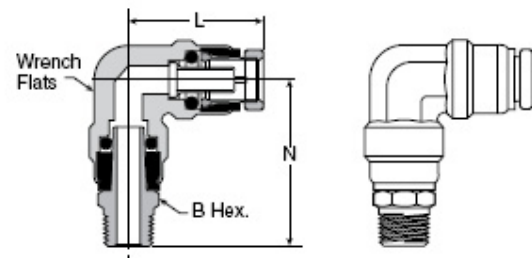

Part No.	Tube Size	Pipe Thread	B Hex.	L	N	Wrench Flats
169PMT-4-2	1/4	1/8	7/16	0.84	1.21	13/32
169PMT-4-4	1/4	1/4	9/16	0.84	1.43	13/32
169PMT-4-6	1/4	3/8	11/16	0.84	1.43	13/32
169PMT-6-2	3/8	1/8	9/16	1.11	1.41	9/16
169PMT-6-4	3/8	1/4	9/16	1.11	1.58	9/16
169PMT-6-6	3/8	3/8	11/16	1.11	1.58	9/16
169PMT-6-8	3/8	1/2	7/8	1.11	1.79	9/16
169PMT-8-4	1/2	1/4	5/8	1.27	1.73	11/16
169PMT-8-6	1/2	3/8	3/4	1.27	1.81	11/16
169PMT-8-8	1/2	1/2	7/8	1.27	1.96	11/16
169PMT-10-6	5/8	3/8	3/4	1.53	2.03	7/8
169PMT-10-8	5/8	1/2	7/8	1.53	2.18	7/8

RACCORD COUDE PASSE-CLOISON

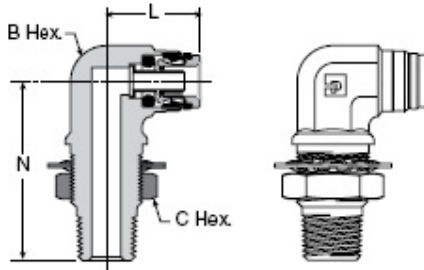

Part No.	Tube Size	Pipe Thread	L	N	B Hex.	C Hex.	Bulkhead Hole Dia.
169PMTBH-6-8	3/8	1/2	1.19	2.50	1-1/4	7/8	1
169PMTBH-8-8	1/2	1/2	1.29	2.50	1-1/4	7/8	1

RACCORD COUDE LONG RIGIDE NPT

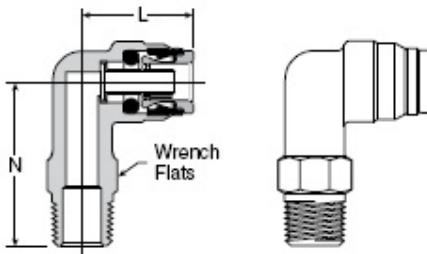

Part No.	Tube Size	Pipe Thread	L	N	Wrench Flats
169PMTL-6-4	3/8	1/4	1.06	1.63	9/16
169PMTL-6-6	3/8	3/8	1.19	2.50	7/8
169PMTL-6-8	3/8	1/2	1.19	2.50	7/8
169PMTL-8-8	1/2	3/8	1.22	2.50	7/8
169PMTL-10-8	5/8	3/8	1.46	2.50	7/8

RACCORD COUDE RIGIDE NPT

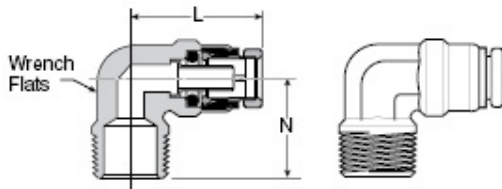

Part No.	Tube Size	Pipe Thread	L	N	Wrench Flats
169PMTNS-4-2	1/4	1/8	0.84	0.72	1/2
169PMTNS-4-4	1/4	1/4	0.84	0.90	1/2
169PMTNS-4-6	1/4	3/8	0.84	1.06	1/2
169PMTNS-6-2	3/8	1/8	1.05	0.75	9/16
169PMTNS-6-4	3/8	1/4	1.05	0.94	9/16
169PMTNS-6-6	3/8	3/8	1.05	0.94	3/4
169PMTNS-6-8	3/8	1/2	1.12	1.26	11/16
169PMTNS-8-4	1/2	1/4	1.17	1.06	11/16
169PMTNS-8-6	1/2	3/8	1.22	1.06	11/16
169PMTNS-8-8	1/2	1/2	1.22	1.26	11/16
169PMTNS-10-6	5/8	3/8	1.46	1.11	7/8
169PMTNS-10-8	5/8	1/2	1.46	1.32	7/8
169PMTNS-12-8	3/4	1/2	1.81	1.44	1

RACCORD COUDE MÉTRIQUE RIGIDE

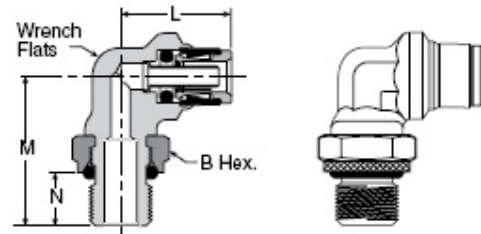

Part No.	Tube Size	Pipe Thread	L	M	N	Wrench Flats (mm)	B Hex. (mm)
169PMTNS-4-M12	1/4	M12x1.5	0.84	1.11	0.37	10	17
169PMTNS-4-M16	1/4	M16x1.5	0.96	1.27	0.41	11	24
169PMTNS-4-M22	1/4	M22x1.5	1.09	1.53	0.41	16	30
169PMTNS-6-M12	3/8	M12x1.5	1.10	1.15	0.66	16	17
169PMTNS-6-M16	3/8	M16x1.5	1.23	1.27	0.41	19	24
169PMTNS-8-M12	1/2	M12x1.5	1.21	1.31	0.37	16	17
169PMTNS-8-M16	1/2	M16x1.5	1.26	1.34	0.41	16	24
169PMTNS-8-M22	1/2	M22x1.5	1.26	1.59	0.41	19	30
169PMTNS-12-M22	3/4	M22x1.5	1.77	1.59	0.41	27	30

RACCORD COUDE PIV NPT

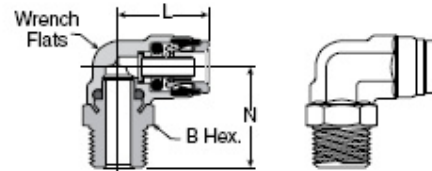

Part No.	Tube Size	Pipe Thread	B Hex.	L	N	Wrench Flats
169PMTR-4-4	1/4	1/4	9/16	0.84	1.13	1/2
169PMTR-6-6	3/8	3/8	3/4	1.12	1.19	9/16
169PMTR-10-8	5/8	1/2	7/8	1.54	1.50	7/8

RACCORD COUDE RIGIDE FEM NPT

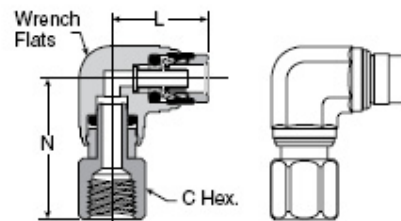

Part No.	Tube Size	Pipe Thread	L	N	C Hex.	Wrench Flats
170PMT-4-2	1/4	1/8-27	0.84	1.18	1/2	1/2

RACCORD COUDE RIGIDE FEM NPT

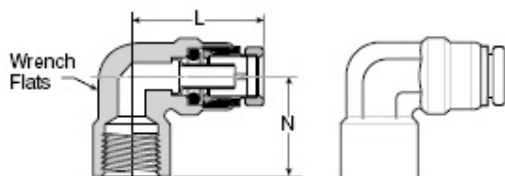

Part No.	Tube Size	Pipe Thread	L	N	Wrench Flats
170PMTNS-4-2	1/4	1/8	.84	0.56	11/16
170PMTNS-4-4	1/4	1/4	1.00	0.67	11/16
170PMTNS-6-2	3/8	1/8	1.12	0.64	9/16
170PMTNS-6-4	3/8	1/4	1.25	1.00	11/16
170PMTNS-6-6	3/8	3/8	1.25	1.00	13/16
170PMTNS-8-4	1/2	1/4	1.25	0.75	11/16
170PMTNS-8-6	1/2	3/8	1.32	0.88	11/16
170PMTNS-8-8	1/2	1/2	1.70	0.98	1

RACCORD EN T PIV NPT

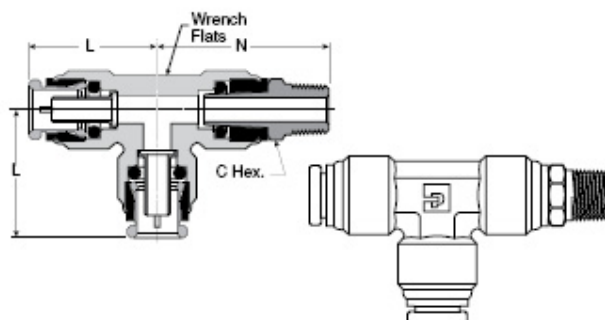

Part No.	Tube Size	Pipe Thread	L	N	C Hex.	Wrench Flats
171PMT-4-2	1/4	1/8	0.85	1.25	7/16	1/2
171PMT-4-4	1/4	1/4	0.85	1.48	9/16	1/2
171PMT-6-2	1/4	3/8	0.85	1.43	11/16	1/2
171PMT-6-4	3/8	1/4	1.21	1.83	9/16	5/8
171PMT-6-6	3/8	3/8	1.21	1.83	11/16	5/8
171PMT-8-4	1/2	1/4	1.27	1.74	5/8	7/8
171PMT-8-6	1/2	3/8	1.27	1.83	3/4	7/8
171PMT-8-8	1/2	1/2	1.27	1.99	7/8	7/8

RACCORD EN T RIGIDE NPT

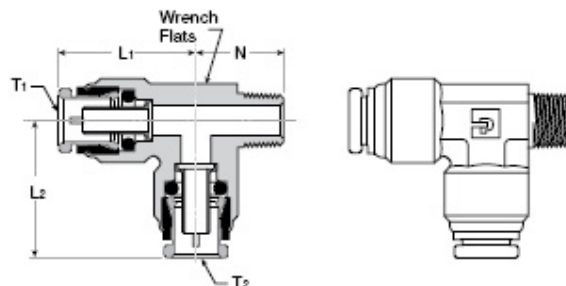

Part No.	Tube 1 Size	Tube 2 Size	Pipe Thread	L1	L2	N	Wrench Flats
171PMTNS-4-2	1/4	1/4	1/8	0.91	0.91	0.77	15/32
171PMTNS-4-4	1/4	1/4	1/4	0.91	0.91	0.94	15/32
171PMTNS-4-6-4	1/4	3/8	1/4	0.93	1.21	0.97	5/8
171PMTNS-6-4	3/8	3/8	1/4	1.21	1.21	0.97	5/8
171PMTNS-6-4-4	3/8	1/4	1/4	1.21	0.93	0.97	5/8
171PMTNS-6-4-6	3/8	1/4	3/8	1.22	0.97	0.93	5/8
171PMTNS-6-6	3/8	3/8	3/8	1.21	1.21	0.97	5/8
171PMTNS-6-8	3/8	3/8	1/2	1.17	1.17	1.26	5/8
171PMTNS-8-4	1/2	1/2	1/4	1.28	1.28	1.06	7/8

RACCORD EN T PIV NPT

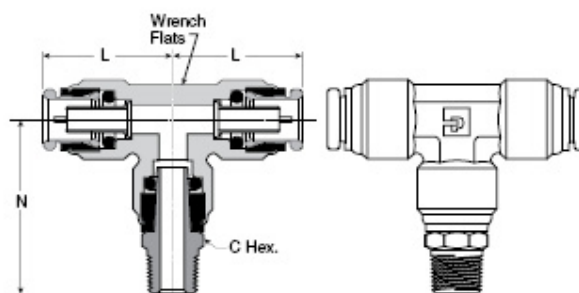

Part No.	Tube Size	Pipe Thread	L	N	C Hex.	Wrench Flats
172PMT-4-2	1/4	1/8	0.85	1.25	7/16	1/2
172PMT-4-4	1/4	1/4	0.85	1.43	9/16	1/2
172PMT-6-2	3/8	1/8	1.22	1.66	9/16	5/8
172PMT-6-4	3/8	1/4	1.22	1.83	5/8	5/8
172PMT-6-6	3/8	3/8	1.22	1.83	3/4	5/8
172PMT-8-4	1/2	1/4	1.27	1.73	5/8	7/8
172PMT-8-6	1/2	3/8	1.27	1.79	3/4	7/8
172PMT-8-8	1/2	1/2	1.27	1.97	7/8	7/8

RACCORD EN T RIGIDE NPT

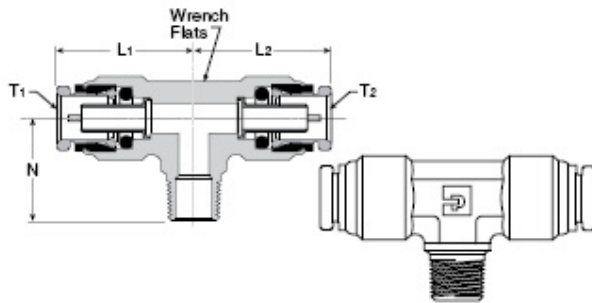

Part No.	Tube 1 Size	Tube 2 Size	Pipe Thread	L1	L2	N	Wrench Flats
172PMTNS-4-2	1/4	1/4	1/8	0.91	0.91	0.78	1/2
172PMTNS-6-4	3/8	3/8	1/4	1.21	1.21	0.97	5/8
172PMTNS-6-4-4	3/8	1/4	1/4	1.21	0.93	0.97	5/8
172PMTNS-6-6	3/8	3/8	3/8	1.21	1.21	0.97	5/8
172PMTNS-6-8	3/8	3/8	1/2	1.17	1.17	1.26	7/8
172PMTNS-8-6	1/2	1/2	3/8	1.28	1.28	1.06	7/8
172PMTNS-8-6-8	1/2	3/8	1/2	1.25	1.25	1.25	7/8
172PMTNS-8-8	1/2	1/2	1/2	1.34	1.34	1.25	7/8

RACCORD EN COUDE PIV NPT

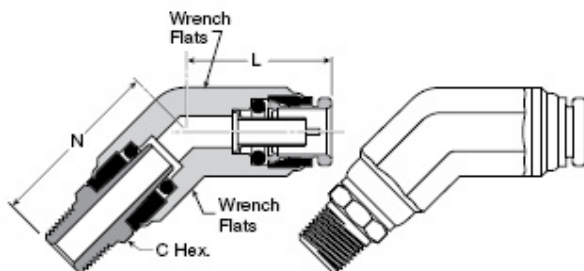

Part No.	Tube Size	Pipe Thread	L	N	C Hex.	Wrench Flats
179PMT-4-2	1/4	1/8	0.79	1.16	7/16	9/16
179PMT-4-4	1/4	1/4	0.89	1.46	9/16	9/16
179PMT-6-2	3/8	1/8	0.99	1.44	5/8	3/4
179PMT-6-4	3/8	1/4	0.99	1.61	5/8	3/4
179PMT-6-6	3/8	3/8	0.99	1.61	5/8	3/4
179PMT-8-4	1/2	1/4	1.20	1.70	5/8	7/8
179PMT-8-6	1/2	3/8	1.20	1.78	3/4	7/8
179PMT-8-8	1/2	1/2	1.20	1.93	7/8	7/8

RACCORD EN COUDE PIV NPT

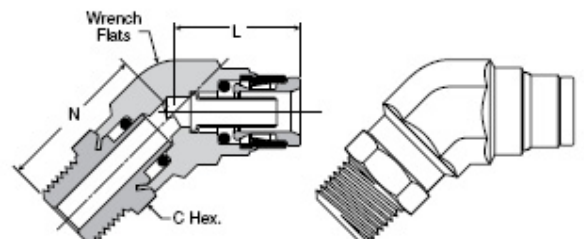

Part No.	Tube Size	Pipe Thread	L	N	C Hex.	Wrench Flats
179PMTR-4-4	1/4	1/4	0.79	1.18	9/16	9/16
179PMTR-8-8	1/2	1/2	1.17	1.35	7/8	7/8

RACCORD EN COUDE RIGIDE NPT

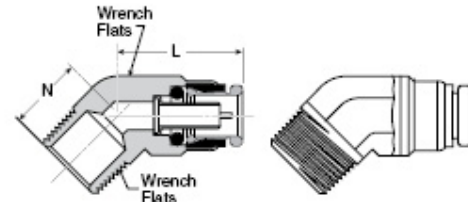

Part No.	Tube Size	Pipe Thread	L	N	Wrench Flats
179PMTNS-4-2	1/4	1/8	0.80	0.56	9/16
179PMTNS-4-4	1/4	1/4	0.80	0.75	9/16
179PMTNS-6-2	3/8	1/8	0.99	0.55	3/4
179PMTNS-6-4	3/8	1/4	0.99	0.73	3/4
179PMTNS-6-6	3/8	3/8	0.99	0.73	3/4
179PMTNS-8-4	1/2	1/4	1.28	0.81	13/16
179PMTNS-8-6	1/2	3/8	1.28	0.81	13/16
179PMTNS-8-8	1/2	1/2	1.28	1.06	13/16
179PMTNS-10-6	5/8	3/8	1.22	0.88	1-1/16
179PMTNS-10-8	5/8	1/2	1.22	1.00	1-1/16
179PMTNS-12-8	3/4	1/2	1.41	1.25	1-1/16

RACCORD DUAL PIV NPT

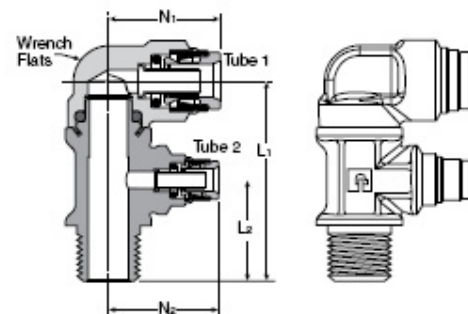

Part No.	Tube 1 Size	Tube 2 Size	Pipe Thread	L1	L2	N1	N2	Wrench Flats
189PMTR-6-4-6	3/8	1/4	3/8	2.12	1.05	1.21	1.19	11/16
189PMTR-6-6-4	3/8	3/8	1/4	2.06	0.98	1.12	1.20	9/16
189PMTR-6-6-6	3/8	3/8	3/8	2.06	0.98	1.12	1.20	9/16
189PMTR-10-6-6	5/8	1/4	3/8	2.18	1.05	1.54	1.19	7/8
189PMTR-10-6-8	5/8	3/8	3/8	2.31	1.12	1.54	1.18	7/8

BOUCHON

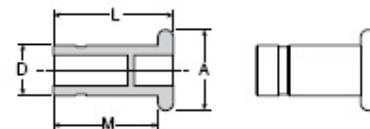

Part No.	Tube Size	L	M	A	D
639PM-5/32BL	5/32	1.09	1.00	0.39	0.156
639PMT-4	1/4	1.14	0.96	0.48	0.250
639PMT-6	3/8	1.33	1.15	0.67	0.375
639PMT-8	1/2	1.33	1.15	0.81	0.500

Specify color when ordering Black (BL) or Blue (BU), example 639PMT-4BU
 Note: use appropriate PM / PMT style connection as determined by part number.



Tube Nylon SAE

Tube O.D. in	Tube I.D. in	100' Slit Pac	500' Reel	1000' Reel	épaisseur mur in	suffixe couleur
1/8	.080	6121.	6521.	6021.	.023	0 = Naturel
1/8	.093	6122.	6522.	6022.	.016	1 = Noir
5/32	.106	6123.	6523.	6023.	.025	2 = Rouge
3/16	.137	6133.	6533.	6033.	.025	3 = Bleu
1/4	.180	6144.	6544.	6044.	.035	4 = Vert
1/4	.125	6146.	6546.	6046.	.062	5 = Jaune
1/4	.170	6147.	6547.	6047.	.040	6 = Orange
5/16	.232	6155.	6555.	6055.	.040	7 = Gris
3/8	.275	6166.	6566.	6066.	.050	
1/2	.375	6188.	6888.	6088.	.062	

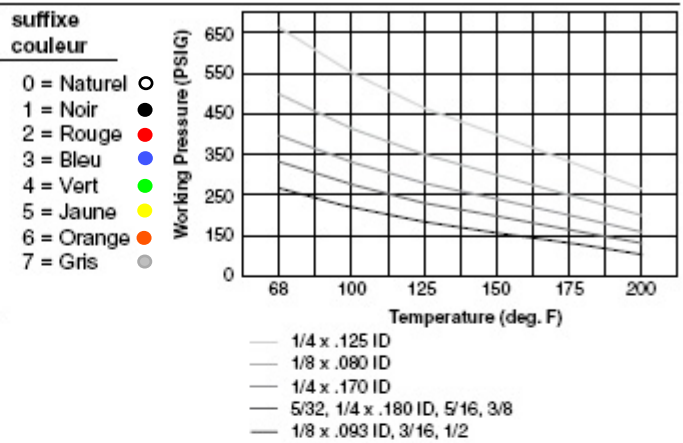

Tube Nylon Métrique

Tube O.D. mm	Tube I.D. mm	100' Slit Pac	500' Reel	1000' Reel	épaisseur mur mm	suffixe couleur
4	2.7	7104.	7404.	7704.	.65	0 = Naturel
4	2.0	7102.	7402.	7702.	1.00	1 = Noir
5	3.0	7105.	7405.	7705.	1.00	2 = Rouge
6	4.0	7106.	7406.	7706.	1.00	3 = Bleu
8	6.0	7108.	7408.	7708.	1.00	4 = Vert
10	8.0	7111.	7411.	7711.	1.00	
10	7.5	7110.	7410.	7710.	1.25	
12	9.5	7112.	7412.	7712.	1.25	
14	12.0	7116.	-	-	1.00	

Ajoutez le suffixe pour la couleur

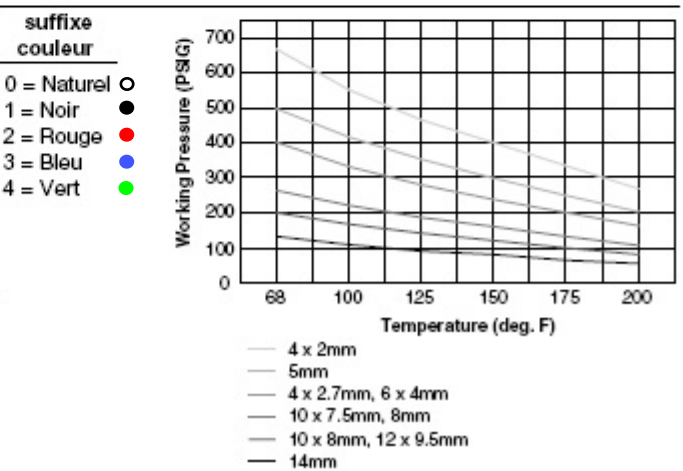

Tube Nylon Air Brake D.O.T.(SAE J844)

Tube O.D. in	Tube I.D. in	100' Slit Pac	500' Reel	1000' Reel	épaisseur mur in	suffixe couleur
1/8	.08	7012.	-	7002.	.023	1 = Noir
5/32	.076	7011.	-	7001.	.040	2 = Rouge
3/16	.117	7013.	-	7003.	.035	3 = Bleu
1/4	.17	7014.	-	7004.	.040	4 = Vert
5/16	.232	7015.	7005.	-	.040	5 = Jaune
3/8	.250	7016.	7006.	-	.062	6 = Orange
1/2	.375	7017.	7007.	-	.062	
5/8	.440	-	7008.	-	.092	
3/4	.566	-	7009.	-	.092	





Tube Polyéthylène SAE

Tube O.D. in	Tube I.D. in	100' Slit Pac	500' Reel	1000' Reel	épaisseur mur in
1/4	.170	6244.	6444.	6644.	.040
5/16	.190	6255.	6455.	6655.	.062
3/8	.250	6266.	6466.	6666.	.062
1/2	.375	6288.	6988.	6688.	.062

suffixe couleur
0 = Naturel
1 = Noir
2 = Rouge
3 = Bleu
4 = Vert
5 = Jaune
6 = Orange
7 = Gris

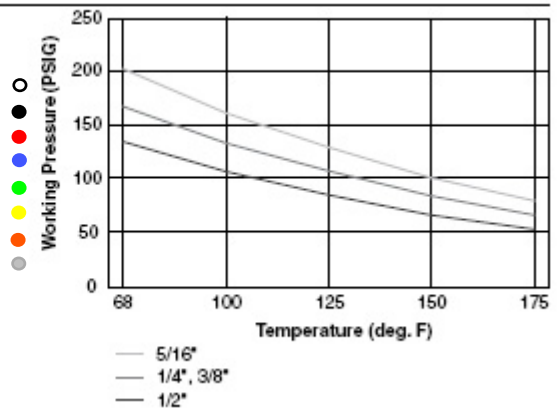

Tube Polyéthylène Métrique

Tube O.D. mm	Tube I.D. mm	100' Slit Pac	500' Reel	1000' Reel	épaisseur mur mm
4	2.5	7203.	7503.	7803.	0.75
6	4.0	7206.	7506.	7806.	1.00
8	6.0	7208.	7508.	7808.	1.00
10	8.0	7211.	7511.	7811.	1.00

suffixe couleur
0 = Naturel
1 = Noir

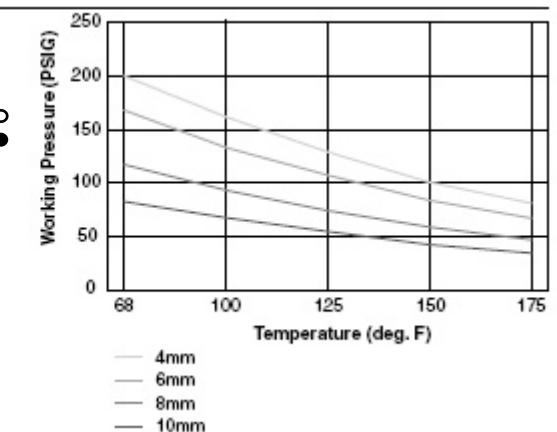

Tube Polyuréthane SAE 95A Duromètre

Tube O.D. in	Tube I.D. in	100' Slit Pac	500' Reel	1000' Reel	épaisseur mur in	suffixe couleur
1/8	.062	6322.	6722.	6622.	.031	0 = Clair 7 = Gris
5/32	.093	6325.	6725.	6625.	.031	1 = Noir 9 = Blanc
3/16	.107	6333.	6733.	6633.	.040	2 = Rouge 12 = Trans Rouge
1/4	.170	6344.	6744.	6645.	.040	3 = Bleu 13 = Trans Blue
1/4	.125	6346.	6746.	6646.	.062	4 = Vert 14 = Trans Green
3/8	.250	6366.	6766.	6667.	.062	5 = Jaune 15 = Trans Yellow
1/2	.320	6387.	6787.	6687.	.090	6 = Orange 16 = Trans Orange

suffixe couleur
0 = Clair
1 = Noir
2 = Rouge
3 = Bleu
4 = Vert
5 = Jaune
6 = Orange
7 = Gris
9 = Blanc
12 = Trans Rouge
13 = Trans Blue
14 = Trans Green
15 = Trans Yellow
16 = Trans Orange

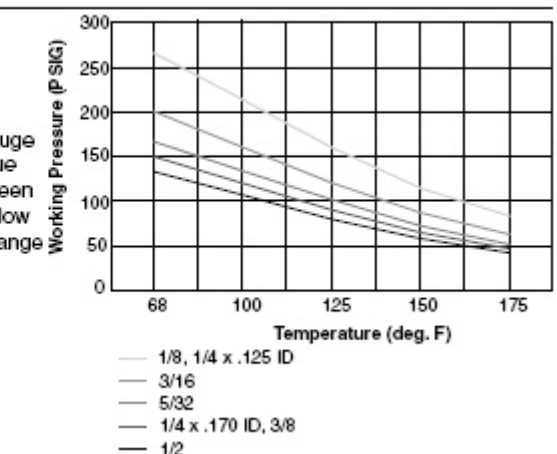



Tube Polyuréthane Métrique 95A Duromètre

Tube O.D. mm	Tube I.D. mm	100' Slit Pac	500' Reel	1000' Reel	épaisseur mur mm	suffixe couleur
4	2.5	7303.	7603.	7903.	0.75	0 = Clair
5	3.0	7305.	7605.	7905.	1.00	1 = Noir
6	4.0	7306.	7606.	7906.	1.00	2 = Rouge
8	6.0	7308.	7608.	7908.	1.00	3 = Bleu
10	6.5	7310.	7610.	7910.	1.75	4 = Vert
12	9.0	7313.	7613.	7913.	1.50	

- Adding a Color Code suffix to the part number is required. If no Color Code is selected, Clear (0) color will be supplied.
- Custom sizes, cut lengths, reel lengths and colors are available upon request—please consult the factory.

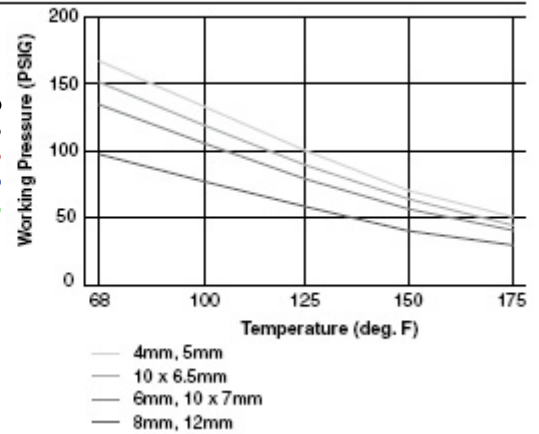

Tube Polyuréthane SAE 85A Duromètre

Tube O.D. in	Tube I.D. in	100' Slit Pac	500' Reel	1000' Reel	épaisseur mur in	suffixe couleur
1/8	.062	S322.	S722.	S622.	.031	0 = Clair
5/32	.093	S325.	S725.	S625.	.031	1 = Noir
1/4	.125	S346.	S746.	S646.	.062	

- Adding a Color Code suffix to the part number is required. If no Color Code is selected, Clear (0) color will be supplied.
- Custom sizes, cut lengths, reel lengths and colors are available upon request—please consult the factory.
- Please refer to pages 48 and 49 for Chemical Resistance information.
- Please refer to pages 50 and 51 for tubing specifications.

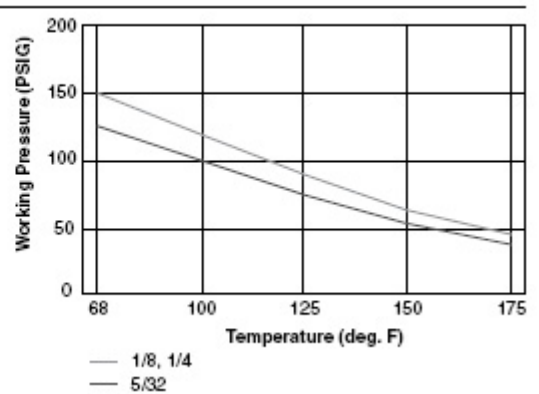

Tubes Polyuréthane Assemblés

- 2 = Naturel & Noir
- 3 = Naturel, Noir & Rouge
- 4 = Naturel, Noir, Rouge & Bleu
- 5 = Naturel, Noir, Rouge, Bleu & Vert
- 6 = Naturel, Noir, Rouge, Bleu, Vert & Jaune

- A = 25 pieds
- B = 50 pieds
- C = 100 pieds

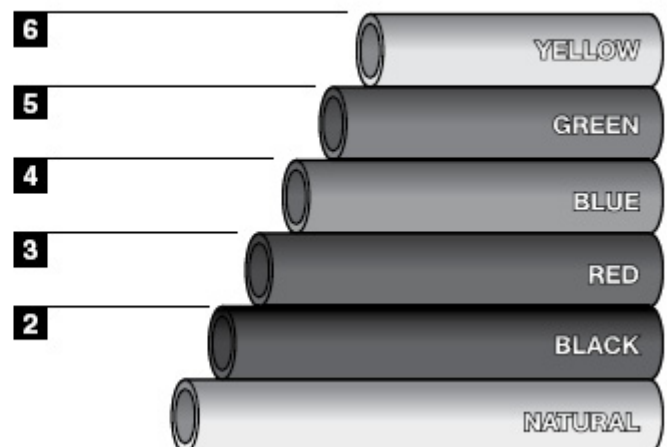

Tubes Polyuréthane Assemblés SAE 95 Duromètre “EZ-Strip”

Tube O.D. in	Tube I.D. in	Part Number	Nombre de Tubes	suffixe longueur
1/8	.062	B322.	2, 3, 4, 5, 6	.A = 25 pieds
5/32	.093	B325.	2, 3, 4, 5, 6	.B = 50 pieds
3/16	.107	B333.	2, 3, 4	.C = 100 pieds
1/4	.125	B346.	2, 3, 4, 5, 6	
3/8	.250	B366.	2, 3, 4, 5, 6	

- Complete the Part Number by adding the correct number for the number of tubes required in the strip and the correct letter for the length. Example: B3254-B = 4 tubes, and 50'.



Tubes Polyuréthane Assemblés SAE 85 Duromètre “EZ-Strip”

Tube O.D. in	Tube I.D. in	Part Number	Nombre de Tubes	suffixe longueur
1/8	.062	BS22.	2, 3, 4, 5, 6	.A = 25 pieds
5/32	.093	BS25.	2, 3, 4, 5, 6	.B = 50 pieds
1/4	.125	BS46.	2, 3, 4, 5, 6	.C = 100 pieds

- Complete the Part Number by adding the correct number for the number of tubes required in the strip and the correct letter for the length. Example: BS254-B = 4 tubes, and 50'.

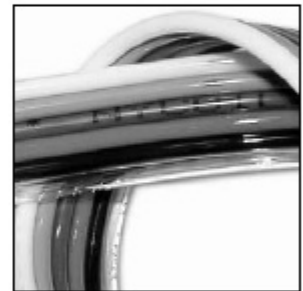

Tubes Nylon 12 Assemblés “Skip-Bond”

Tube O.D. in	Tube I.D. in	Part Number	Nombres de Tubes	suffixe longueur
1/8	.080	B121.	2, 3, 4	.A = 25 pieds
1/8	.093	B122.	2, 3, 4	.B = 50 pieds
5/32	.106	B123.	2, 3, 4	.C = 100 pieds
3/16	.137	B133.	2, 3, 4	
1/4	.180	B144.	2, 3, 4	
3/8	.275	B166.	2, 3, 4	

- Complete the Part Number by adding the correct number for the number of tubes required in the strip and the correct letter for the length. Example: B1444-B = 4 tubes, and 50'.

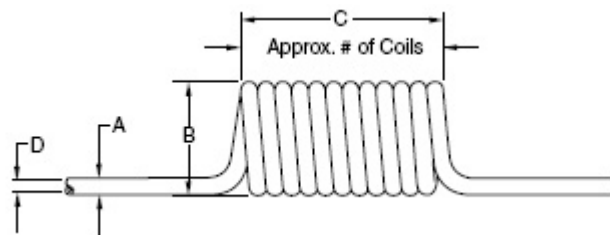

Tubes Polyuréthane Mini-Coil 95 Duromètre

Tube O.D.	Tube I.D.	Part Number	Total Length (in)	Length w/o Tails (in)	Number of Coils	Coil I.D. (in)	Coil O.D. "B"(in)	Compact Length "C"(in)	Couleurs	suffixe couleur
1/8	1/16	4822.	24	12	6	1/2	3/4	3/4	0,1,2,3,4,5,6,7	0 = Clair ○
1/8	1/16	4823.	36	24	12	1/2	3/4	1-1/2	0,1,2,3,4,5,6,7	1 = Noir ●
1/8	1/16	4824.	48	36	18	1/2	3/4	2-1/4	0,1,2,3,4,5,6,7	2 = Rouge ●
1/8	1/16	4825.	60	48	23	1/2	3/4	3	0,1,2,3,4,5,6,7	3 = Bleu ●
5/32	3/32	4812.	24	12	6	1/2	7/8	1	0,1,2,3,4,5,6,7,13	4 = Vert ●
5/32	3/32	4813.	36	24	12	1/2	7/8	1-3/4	0,1,2,3,4,5,6,7,13	5 = Jaune ●
5/32	3/32	4815.	60	48	23	1/2	7/8	3-1/2	0,1,2,3,4,5,6,7,13	6 = Orange ●
5/32	3/32	4817.	84	72	24	3/4	1-1/8	3-3/4	0,1,2,3,4,5,6,7,13	7 = Gris ●
5/32	3/32	4810.	120	108	35	3/4	1-1/8	5-1/2	0,1,2,3,4,5,6,7,13	13 = Trans. Bleu ●
1/4	1/8	4843.	36	24	6	1	1-1/2	1-1/2	0,1,2,3,4,5,6,7,13	
1/4	1/8	4845.	60	48	12	1	1-1/2	3	0,1,2,3,4,5,6,7,13	
1/4	1/8	4847.	84	72	18	1	1-1/2	4-1/2	0,1,2,3,4,5,6,7,13	
1/4	1/8	4840.	120	108	26	1	1-1/2	6-1/2	0,1,2,3,4,5,6,7,13	
3/8	1/4	4865.	60	48	7	1-3/4	2-1/2	2-3/4	0,1,2,3,4	
3/8	1/4	4860.	120	108	15	1-3/4	2-1/2	5-3/4	0,1,2,3,4	

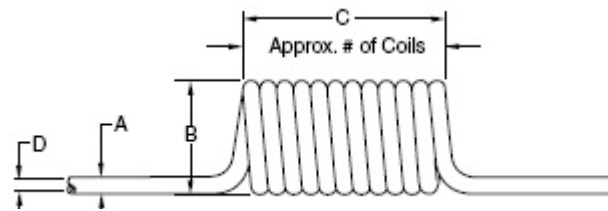

Tubes Nylon 12 Mini-Coil

Tube O.D.	Tube I.D.	Part Number	Total Length (in)	Length w/o Tails (in)	Number of Coils	Coil O.D. "B"(in)	Compact Length "C"(in)	Couleurs	suffixe couleur
5/32	.106	4112.	24	16	5	1-1/2	7/8	0,1,2,3	0 = Naturel ○
5/32	.106	4113.	36	28	8	1-1/2	1-1/4	0,1,2,3	1 = Noir ●
5/32	.106	4115.	60	52	12	1-1/2	1-7/8	0,1,2,3	2 = Rouge ●
5/32	.106	4116.	72	64	19	1-1/2	3	0,1,2,3	3 = Bleu ●
5/32	.106	4110.	120	112	32	1-1/2	5	0,1,2,3	
1/4	.180	4143.	36	28	6	2	1-1/2	0,1,2,3	
1/4	.180	4145.	60	52	10	2	2-1/2	0,1,2,3	
1/4	.180	4147.	84	76	15	2	3-3/4	0,1,2,3	
1/4	.180	4149.	108	100	19	2	4-3/4	0,1,2,3	
5/16	.232	4154.	48	40	6	2-5/8	1-7/8	0,1,2,3	
5/16	.232	4156.	72	64	10	2-5/8	3-1/8	0,1,2,3	
5/16	.232	4150.	120	112	16	2-5/8	5	0,1,2,3	



Polyurethane

Polyurethane tubing is usually the best choice for applications requiring extensive flexing, a small bend radius or where kinking can be a problem. Nycoil uses ether base (polytetra-methylene glycol ether) raw material because of its hydrolytic resistance (will not break down or be affected in any way by moisture). Being a naturally rubbery compound, it requires no plasticizers that can leach out over time. This compound also offers superior resistance to grease, oils, fuels and abrasion, making it suitable for a wide variety of applications.

Due to its lower burst and temperature characteristics, the uses for Polyurethane is best recommended on applications where the flow rate is not critical and temperature elevation of the tubing is not a factor. When using Polyurethane tubing in most pneumatic systems, one size larger tube is often required in order to meet the necessary flow criteria.

As a result, applications should be limited to areas of consistent low temperatures and where high and continued flexibility is essential. A typical example of this would be a "pick and place" operation.

Since Nycoil "Poly-Matic" Push-To-Connect Fittings have the highest gripping "force" as compared to other brands, it is assured that our tubing will always work with our fittings. However, when using Push-To-Connect Fittings from other manufacturers with any brand of Polyurethane tubing, testing for retention reliability is strongly recommended. Further, we recommend using only Polyurethane tubing made from 95A Durometer hardness compound with Push-To-Connect Fittings. In addition, compression type fittings should never be used with Polyurethane tubing of any hardness.

Temperature Range: -40°F to +165°F (-40°C to +75°C)

95A Durometer Polyurethane Tubing

Although 95A Durometer is the hardest compound used for Polyurethane tubing, it is still more flexible and has a smaller bend radius (without kinking) than most other plastic tubing. Produced from ether base (polytetra-methylene glycol ether) raw material assures resistance to moisture, fungus, abrasion and a broad range

of chemicals making it a popular choice for many applications. A wide selection of colors makes it adaptable to the functional and aesthetic requirements of most pneumatic circuits and equipment. 95A Durometer Polyurethane Tubing can be used with most brands of Push-To-Connect or Hose Barb Fittings.

95A Durometer Polyurethane Fractional Inch Tubing

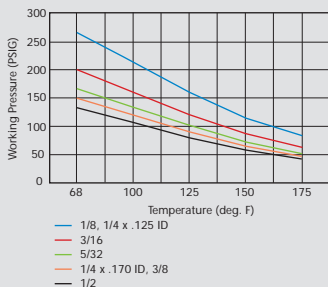

Tube O.D. in	Tube I.D. in	100' Slit Pac	500' Reel	1000' Reel	Wall Thickness in	Color Code Suffix Key
1/8	0.062	6322_	6722_	6622_	0.031	0 = Clear 7 = Gray
5/32	0.093	6325_	6725_	6625_	0.031	1 = Black 9 = White
3/16	0.107	6333_	6733_	6633_	0.040	2 = Red 12 = Transparent Red
1/4	0.170	6344_	6744_	6645_	0.040	3 = Blue 13 = Transparent Blue
1/4	0.125	6346_	6746_	6646_	0.062	4 = Green 14 = Transparent Green
3/8	0.250	6366_	6766_	6667_	0.062	5 = Yellow 15 = Transparent Yellow
1/2	0.320	6387_	6787_*	6687_	0.090	6 = Orange 16 = Transparent Orange

* Indicates 250' Reel

- Adding a Color Code suffix to the part number is required. If no Color Code is selected, Clear (0) color will be supplied.
- Custom sizes, cut lengths, reel lengths and colors are available upon request—please consult the factory.
- Please refer to pages 48 and 49 for Chemical Resistance information.
- Please refer to pages 50 and 51 for tubing specifications.

95A Durometer Polyurethane Metric Tubing

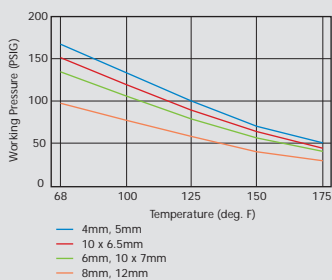

Tube O.D. mm	Tube I.D. mm	100' Slit Pac	500' Reel	1000' Reel	Wall Thickness mm	Color Code Suffix Key
4	2.5	7303_	7603_	7903_	0.75	0 = Clear
5	3	7305_	7605_	7905_	1	1 = Black
6	4	7306_	7606_	7906_	1	2 = Red
8	6	7308_	7608_	7908_	1	3 = Blue
10	6.5	7310_	7610_	7910_	1.75	4 = Green
12	9	7313_	7613_	7913_	1.5	

- Adding a Color Code suffix to the part number is required. If no Color Code is selected, Clear (0) color will be supplied.
- Custom sizes, cut lengths, reel lengths and colors are available upon request—please consult the factory.
- Please refer to pages 48 and 49 for Chemical Resistance information.
- Please refer to pages 50 and 51 for tubing specifications.

See page 10 for 85A Durometer Polyurethane Tubing.