

Large Frame Reels



reelcraft.com

 **REELCRAFT**[®]



CA33112 L

Hand
Crank

Hand Crank & Motor Driven Air/Water/Oil - 1/2", 3/4", 1" I.D.

Reelcraft's Series 30000 reels are designed for rugged, heavy duty applications requiring long lengths of hose and large storage capacity. All-bolted unitized construction with no welds to fatigue. Full flow swivel and heavy gauge steel frame, spool and drum ensure longest service life.

DIMENSIONS & SPECS					
HOSE I.D.	1/2"	3/4"	1"		
	(12.70mm)	(19.05mm)	(25.40mm)		
	.854"	1.188"	1.380"		
HOSE O.D.	1/2"	3/4"	1"		
	(21.5mm)	(30.2mm)	(35.0mm)		
"B" WIDTH	WEIGHT	HOSE CAPACITY			
6"	38 lb	100'	50'	N/A	
(153 mm)	(18 kg)	(31 m)	(16 m)		
12"	46 lb	200'	100'	N/A	
(305 mm)	(21 kg)	(61 m)	(31 m)		
18"	54 lb	325'	175'	100'	
(458 mm)	(25 kg)	(99 m)	(54 m)	(31 m)	

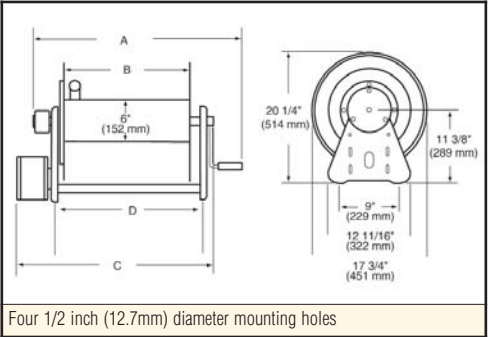

Note: Weights listed are for crank driven - Add for power driven, electric - all explosion proof 45 lb. (20.41 kg); 12 Volt D.C. 1/3 H.P. 30 lb. (13.61 kg); Air 6 AM 36 lb. (16.33 kg).
*Note: capacity chart is reference only.

For all metric thread connections over 1/2" add the suffix number 70 to indicate BSPT threads - example CA33112 M70.

SPECIFICATIONS

MODEL	HOSE I.D.		HOSE O.D.		(F)NPTF REEL INLET	CAPACITY	WEIGHT	PRESSURE	A	B	C	D						
	in / mm	in / mm	in / mm	in / mm														
HAND CRANK																		
CA32106 L	1/2	13	.845	21.5	1/2	100	31	42	19	1000	69	19	483	6	153	N/A	9 3/4	248
CA32112 L	1/2	13	.845	21.5	1/2	200	61	49	22	1000	69	25	635	12	305	N/A	15 3/4	400
CA33106 L	3/4	19	1.188	30.2	3/4	50	16	43	20	1000	69	19	483	6	153	N/A	9 3/4	249
CA33112 L	3/4	19	1.188	30.2	3/4	100	31	42	19	1000	69	25	635	12	305	N/A	15 3/4	400
CA33118 L	3/4	19	1.188	30.2	3/4	175	54	56	25	1000	69	31	787	18	458	N/A	21 3/4	553
CA37118 L	1	25	1.380	35.0	1	100	31	58	26	300	21	34	864	18	458	N/A	21 3/4	553
CA32112 M	1/2	13	.845	21.5	1/2	200	61	49	22	3000	207	25	635	12	305	N/A	15 3/4	400
CA33112 M	3/4	19	1.188	30.2	3/4	100	31	53	24	3000	207	25	635	12	305	N/A	15 3/4	400
CA33118 M	3/4	19	1.188	30.2	3/4	175	54	54	25	3000	207	31	787	18	458	N/A	21 3/4	553

ELECTRIC MOTOR DRIVEN REELS

EA32118 L12D	1/2	13	.845	21.5	1/2	325	99	71	32	1000	69	N/A	18	458	29 5/8	753	21 3/4	553
EA33112 L12D	3/4	19	1.188	30.2	3/4	100	31	70	31	1000	69	N/A	12	305	23 5/8	600	15 3/4	400

All 30000 series reels are supplied without hose. Assemblies quoted upon request. *Series 37000 reels do not have a gooseneck. NOTE: Many more reel models available in addition to chart. Please call manufacturer for details on models not listed.

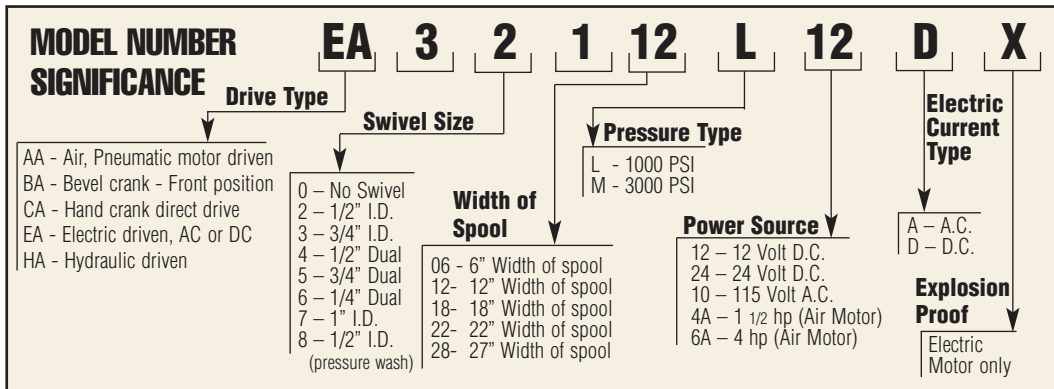

- ✓ Adjustable spool rotation drag that eliminates hose backlash
- ✓ Nickel-plated swivel with four "O" ring options: AFLAS (std), Buna, Viton® or -EPR* seals *Standard swivel
- ✓ Optional lock pin to prevent spool rotation when the reel is not in use S600874
- ✓ Temperature operating range from -20° F (-29° C) to +250° F (121° C)

NOTE: This chart is for reference purposes only. Reels cannot be ordered by selecting from this chart. Please see selection charts or consult manufacturer for additional models not listed in selection chart or for any questions about option combinations.

North America: **800-444-3134**

Europe: **+44 (0) 1536 406999**

reelcraft.com

China: **+86 (519) 8512 2391**

Pacific Rim: **+63 (45) 625-6624**

Latin America: **260-489-1685**

Reelcraft Industries is
ISO 9001:2000
Certified Since 1996

Models listed with an icon can be shipped same day upon request when the order is received by 11:30 AM local time for quantities of 5 or fewer.

Indiana Warehouse

Indiana & California Warehouses

California Warehouse

Canadian Warehouse



Large Frame Reels Nordic™ Series 1200

Heavy Duty Large Frame Reels Nordic™ Series 1200

1" Fluid Path for 1/2" through 1" I.D. Hose

Rewind: Direct crank rewind or chain and sprocket drive powered by A.C. or D.C. electric motor, compressed air motor or hydraulic motor. Crank is not supplied on power rewind models. A pin lock assembly is optional on manual rewind reels. A 3/8" pitch chain is standard.

Inlet: 1/2" up to 1" female/male NPT 90° swivel joint. Straight swivel joint may be specified at extra cost.

Gooseneck: 1/2", 3/4", 1" female NPT. Other sizes and/or threads, including garden hose thread, can be furnished when specified.

The standard color for this series is red.

NEW!

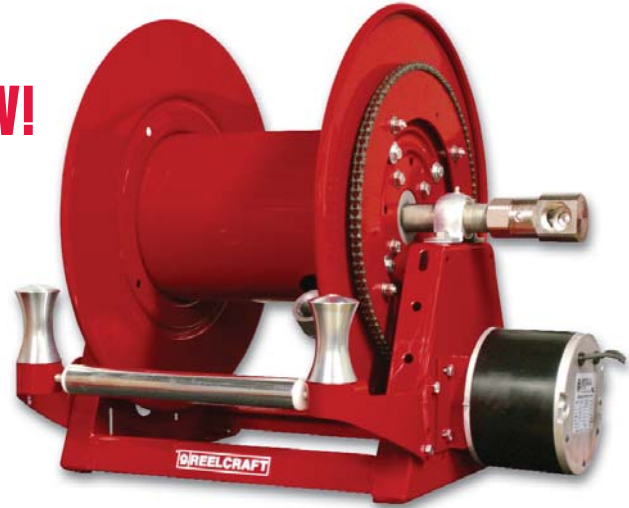

Nordic Series 1200

Shown with optional three-way roller bracket.

Nonexplosion-proof motor is standard "E" (pictured). Explosion proof (EP) motor is available upon request.

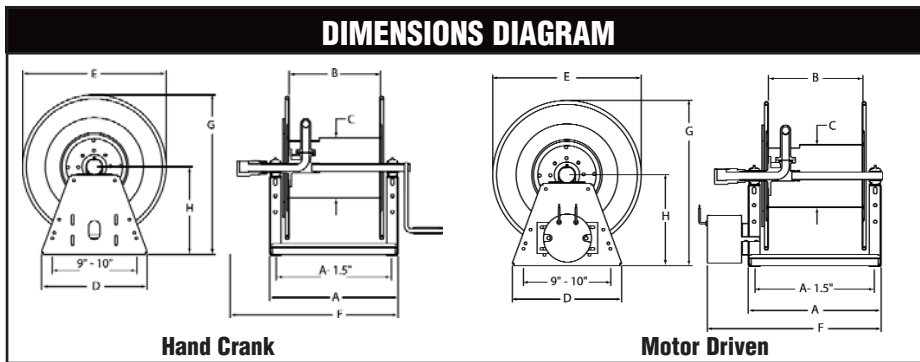

Product temperatures range from -20° to +225°F and standard pressures to 3000 PSI. Other temperatures or pressures can be furnished at extra cost; consult manufacturer.

Made in USA

HOSE I.D.		1/2	3/4	1	SPECIFICATIONS - HOSE CAPACITY AND REEL DIMENSIONS														
HOSE O.D.		0.845	1.18	1.4	KEY: CRK = hand crank; "E" = nonexplosion-proof electric motor; EP = explosion-proof motor; AIR = air motor; BEVEL = bevel crank														
MODEL	HOSE LENGTH	WT CRANK*	WT MOTOR*	WT BEVEL*	A	B	C	D	E	F CRK	F "E"	F EP	F AIR	F BEVEL	G	H			
1200-19-6	ft	100	50	35	41 LB	58 LB	48 LB	11	6	8	14	19	22	16.5	18.5	16	22	21	11.6
	m	30	15	11	19 KG	26 KG	22 KG	279	152	203	356	483	559	419	470	406	559	533	295
1200-19-12	ft	200	100	70	43 LB	60 LB	50 LB	17	12	8	14	19	28	22.5	24.5	22	28	21	11.6
	m	61	30	21	20 KG	27 KG	23 KG	432	305	203	356	483	711	572	622	559	711	533	295
1200-19-18	ft	300	150	105	44 LB	61 LB	51 LB	23	18	8	14	19	34	28.5	30.5	28	34	21	11.6
	m	91	46	32	20 KG	28 KG	23 KG	584	457	203	356	483	864	724	775	711	864	533	295
1200-19-22	ft	365	180	125	45 LB	62 LB	52 LB	27	22	8	14	19	38	32.5	34.5	32	38	21	11.6
	m	111	55	38	20 KG	28 KG	24 KG	686	559	203	356	483	965	826	876	813	965	533	295
1200-19-28	ft	465	230	160	46 LB	63 LB	53 LB	33	28	8	14	19	44	38.5	40.5	38	44	21	11.6
	m	142	70	49	21 KG	29 KG	24 KG	838	711	203	356	483	1118	978	1029	965	1118	533	295
1200-23-6	ft	150	75	50	49 LB	66 LB	56 LB	11	6	11.25	15.25	23	22	16.5	18.5	16	22	25.1	13.6
	m	46	23	15	22 KG	30 KG	25 KG	279	152	286	387	584	559	419	470	406	559	638	345
1200-23-12	ft	300	150	100	51 LB	68 LB	58 LB	17	12	11.25	15.25	23	28	22.5	24.5	22	28	25.1	13.6
	m	91	46	30	23 KG	31 KG	26 KG	432	305	286	387	584	711	572	622	559	711	638	345
1200-23-18	ft	450	225	150	52 LB	69 LB	59 LB	23	18	11.25	15.25	23	34	28.5	30.5	28	34	25.1	13.6
	m	137	69	46	24 KG	31 KG	27 KG	584	457	286	387	584	864	724	775	711	864	638	345
1200-23-22	ft	550	275	180	53 LB	70 LB	60 LB	27	22	11.25	15.25	23	38	32.5	34.5	32	38	25.1	13.6
	m	168	84	55	24 KG	32 KG	27 KG	686	559	286	387	584	965	826	876	813	965	638	345
1200-23-28	ft	700	350	230	54 LB	71 LB	61 LB	33	28	11.25	15.25	23	44	38.5	40.5	38	44	25.1	13.6
	m	213	107	70	24 KG	32 KG	28 KG	838	711	286	387	584	1118	978	1029	965	1118	638	345

*Estimated weight on carbon steel frame.

North America: 800-444-3134
Europe: +44 (0) 1536 406999
reelcraft.com

China: +86 (519) 8512 2391
Pacific Rim: +63 (45) 625-6624
Latin America: 260-489-1685



Reelcraft's Engineered Product Solutions

Full Flow Design

The goose neck is contoured to match the drum diameter, which allows smooth hose wrapping and unimpeded flow.

Long Service Life

Swivel incorporates a permanently lubricated ball bearing.

Adjustable Hose Tension

The brake can be adjusted to suit the application requirements.

Trouble-Free Rewinding

Chain and sprocket drive ensures smooth and consistent operation.

Meets or Exceeds Military Vibration for Truck Transport test.

MIL-STD-810F
500,000 mile equivalent

Long Service Life

The spool axial is supported by independent self-aligning bearing.

Free Rotation While Pressurized

The swing joint and spindle allows reel to freely rotate while fluid is pressurized.

Precise Rigid Construction

Proprietary unitized tie rods are zinc plated offering greater strength and resistance to vibration and corrosion.

Ultimate Corrosion Resistance

Individually powder coated components insure maximum coverage and resistance to corrosion. Stainless steel fasteners are standard.

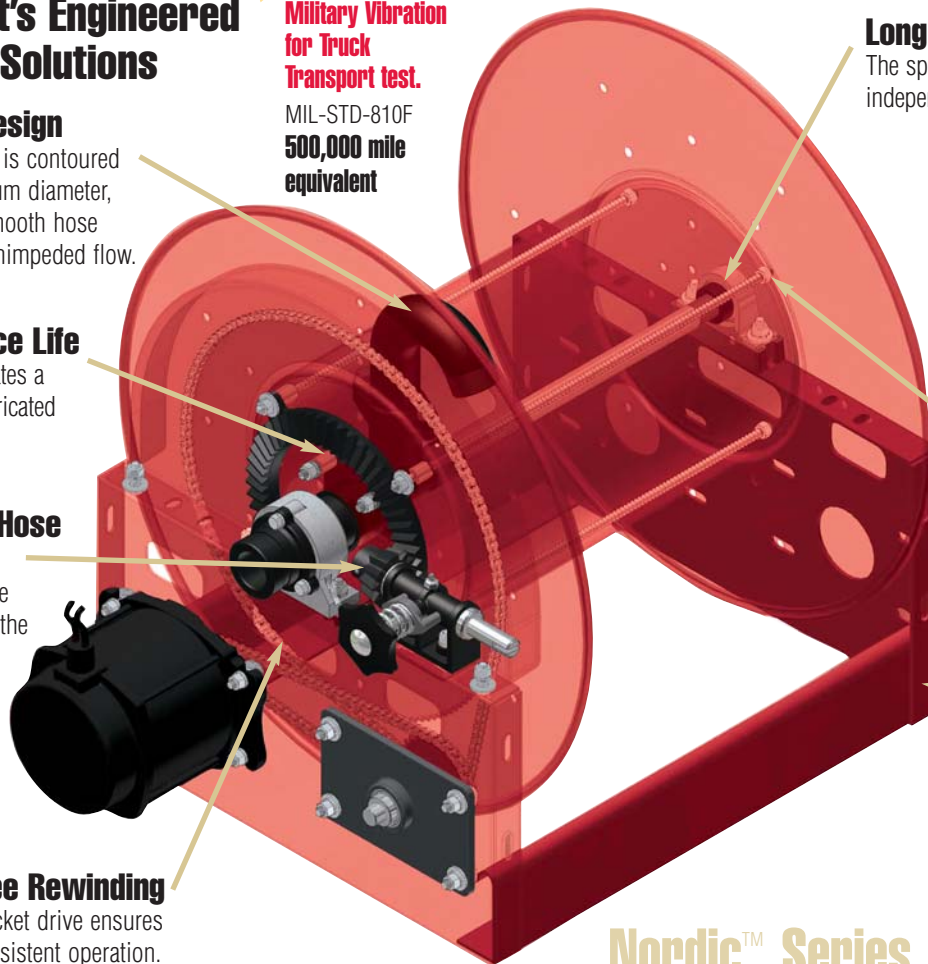

Nordic™ Series

Drive Options	Series	Head Dia.	Drum Length	Thread Size	Thread Type	Thread Style	Fluid Path Material	Pressure	Inlet Style	Fluid Path Location/Direction	Color Code
E 12 VDC	1200	19	6"-36" in 2" increments	50 1/2"	F Female Outlet	NP NPT	A Aluminum	LP 0-600	1 Straight	1 Left Hand Top Wind	R Red
NJ 24 VDC	2400	21		75 3/4"	FF Female In/Out	BP BSPP	D Ductile Iron	1K 600-1000	2 90 Degree	2 Left Hand Bottom Wind	B Black
EP *12 VDC Exp	3900	23		10 1"	M Male Outlet	BT BSPT	S Stainless	3K 1000-3000	5 1" LPG	3 Right Hand Top Wind	W White
EA *115 VAC Exp	3700	25		12 1 1/4"	MM Male In/Out		B Bronze	5K 3001-5000	6 1 1/2" LPG	4 Right Hand Bottom Wind	G Grey
EJ *24 VDC Exp	5900	28		15 1 1/2"	V Victaulic			6K 5001-6000	7 2" LPG		S Silver
HD Hydraulic		31		20 2"				10K 10,000			
AF 1 1/2 HP Air		36		25 2 1/2"				15K 15,000			
AR 4 HP Air		39		30 3"							
BC Bevel Crank		46		40 4"							
HC Hand Crank											
S Storage											
CR Cable Reel											

Material Options/ Drive Size	Code
1/2" Pitch Chain	##5
5/8" Pitch Chain	##6
3/4" Pitch Chain	##7
Gear Driven	##9
Alum. Frame/Spool	##5#
304 S.S. Frame/Spool	##9#
316 S.S. Frame/Spool	##8#
Sewer Cleaning Reel	##15
Twin Hose	###T

Additional Options
Idler
Chain Guard
Roller Bracket (Top)
Roller Bracket (Bottom)
Inboard Motor
Brake
Auxiliary Bevel Crank
Hose Boss (Guide)
Junction Box
Explosion Proof Switch
Solenoid
Circuit Breaker
Control Valve

Part No. Example: EP3900-23-28-15FFNPALP21-R00
 EP(12VDC Electric Explosion Proof Motor)
 3900(Series 3900 Hose Reel)
 -23(23" Head Dia.) -28(28" Drum Length)
 -15(1-1/2" Thread Size) FF(Female In/Out Thread Type)
 NP(NPT Thread Style) A(Aluminum Fluid Path)
 LP(0-600 PSI) 2(90° Inlet)
 1(Left Hand Top Wind Fluid Path Location/Direction)
 R(Red)

NOTE: Not all options available in every combination. Please contact manufacturer for price and availability.

North America: 800-444-3134

Europe: +44 (0) 1536 406999

reelcraft.com

China: +86 (519) 8512 2391

Pacific Rim: +63 (45) 625-6624

Latin America: 260-489-1685

Reelcraft Industries is
ISO 9001:2000
Certified Since 1996

Models listed with an icon can be shipped same day upon request when the order is received by 11:30 AM local time for quantities of 5 or fewer.



Indiana Warehouse



California Warehouse



Indiana & California
Warehouses



Canadian Warehouse



Large Frame Reels Nordic™ Series 2400

Heavy Duty Large Frame Reels Nordic™ Series 2400

1/2", 3/4" or 1" Fluid Path for 1/2" through 1" I.D. Hose

Rewind: Gear-drive rewind (new) or chain and sprocket drive powered by A.C. or D.C. electric motor, compressed air motor or hydraulic motor.

Inlet: 1/2" up to 1" female/male NPT 90° swivel joint. Straight swivel joint may be specified at extra cost.

Gooseneck: 1/2" up to 1" female/male NPT. Other sizes and/or threads, including male NST and male garden hose thread, can be furnished when specified.

Product temperatures from -20° to +225°F and standard pressures to 3000 p.s.i. Reels to operate at other temperatures or pressures can be furnished at extra cost, consult manufacturer. The standard color for this series is red or gray. ADD 12" to E dimension when crank is in rewind position.

Made in USA

NEW!
Gear drive
option

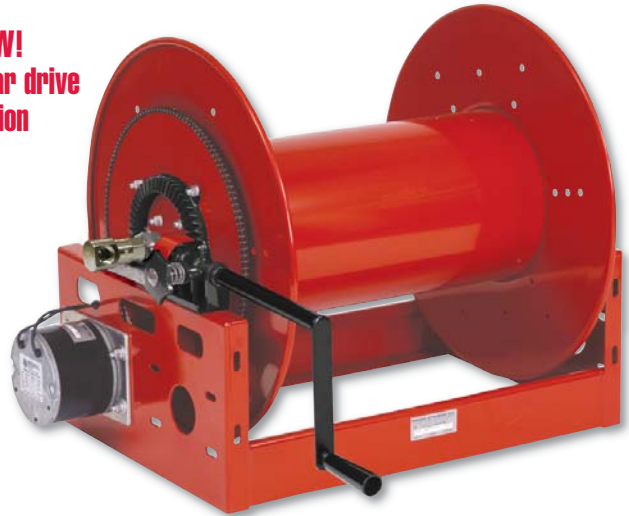

**1/2" pitch chain
now standard**

Shown with optional
bevel crank.

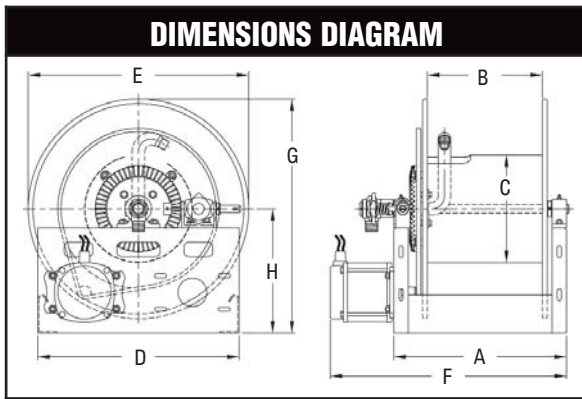

Fire Service / Booster Reels

The **aluminum Series 2400** reel for booster hose is corrosion-resistant and weighs up to 50% less than standard steel booster reels. Features include an aluminum spool and frame assembly, plated steel fluid path and plated sprocket and fasteners. **No painting or finishing is required.**



Nordic Series 2455

HOSE I.D.		in	1/2	3/4	1															
		mm	13	19	25															
HOSE O.D.		in	.875	1.281	1.563															
		mm	22	33	40															
MODEL	HOSE LENGTH (other std. lengths available)				EST. WEIGHT		A	B	C	D	E CRK	E ELC	E AIR	E HYD	F CRK	F ELC	F AIR	F HYD	G	H
	ft	m	ft	m																
2400-19-16	ft	200	100	50	70 LB	in	21	16	11.25	21	21	21	22	21	26	29	26	28	22.5	13
	m	61	30	15	32 KG	mm	533	406	286	533	533	533	559	533	660	737	660	711	572	330
2400-23-14	ft	315	150	100	74 LB	in	20	14	11.25	21	23	23	24	23	24	27	24	26	24.5	13
	m	96	46	30	34 KG	mm	508	356	286	533	584	584	610	584	610	686	610	660	622	330
2400-23-18	ft	485	240	150	78 LB	in	24	18	11.25	21	23	23	24	23	28	31	28	30	24.5	13
	m	148	73	46	35 KG	mm	610	457	286	533	584	584	610	584	711	787	711	762	622	330
2400-23-20	ft	535	260	165	80 LB	in	26	20	11.25	21	23	23	24	23	30	33	30	32	24.5	13
	m	163	79	50	36 KG	mm	660	508	286	533	584	584	610	584	762	838	762	813	622	330
2400-23-24	ft	625	300	200	84 LB	in	30	24	11.25	21	23	23	24	23	34	37	34	36	24.5	13
	m	191	91	61	38 KG	mm	762	610	286	533	584	584	610	584	864	940	864	914	622	330
2400-25-8	ft	235	125	60	72 LB	in	14	8	11.25	21	25	25	25	25	18	21	18	20	26.5	14
	m	72	38	18	33 KG	mm	356	203	286	533	635	635	635	635	457	533	457	508	673	356
2400-25-14	ft	450	225	110	74 LB	in	20	14	11.25	21	25	25	25	25	24	27	24	26	26.5	14
	m	137	69	34	34 KG	mm	508	356	286	533	635	635	635	635	610	686	610	660	673	356
2400-31-8	ft	435	185	125	74 LB	in	14	8	11.25	24	31	31	31	31	18	21	18	20	32.5	17
	m	133	56	38	34 KG	mm	356	203	286	610	787	787	787	787	457	533	457	508	826	432
2400-31-10	ft	540	235	165	76 LB	in	16	10	11.25	24	31	31	31	31	20	23	20	22	32.5	17
	m	165	72	50	34 KG	mm	406	254	286	610	787	787	787	787	508	584	508	559	826	432
2400-31-16	ft	900	400	300	80 LB	in	22	16	11.25	24	31	31	31	31	26	29	26	28	32.5	17
	m	274	122	91	36 KG	mm	559	406	286	610	787	787	787	787	660	737	660	711	826	432

SPECIFICATIONS - HOSE CAPACITY AND REEL DIMENSIONS
KEY: CRK = hand crank; ELC = electric motor; EXP = explosion-proof motor; AIR = air motor; BEVEL = bevel crank

Refer to page 4 to build a complete model number. Refer to chart on page 6 for weight adders.

North America: **800-444-3134** China: **+86 (519) 8512 2391**
Europe: **+44 (0) 1536 406999** Pacific Rim: **+63 (45) 625-6624**
reelcraft.com Latin America: **260-489-1685**



Modular Large Frame Reels Series 40 - 1", 1¼", 1½" I.D.

Flexible Configurations

- ✓ Standard straight ball bearing swivel joint with female NPT threads and 2" victaulic groove. 90° swivel available, no extra charge.
- ✓ Hand crank, bevel crank, gear and chain drives in chart.
- ✓ Also available as standard, explosion proof 12VDC, 115 AC, hydraulic and pneumatic motor.
- ✓ Powder coated steel flanges included, aluminum also available as standard.
- ✓ Open spool spacer allows for easy access to reversible goose neck and open spool design allows for hose flexing under pressure without spool distortion.
- ✓ Plumbing and motor shown on left side; however, any configuration is available as a standard order.
- ✓ Standard colors are powder coat red with black frame. Other colors available upon request.
- ✓ Max pressure: 600 psi. Standard seals maximum temperature 174° F (79° C) and minimum temperature -20° F (-29° C). Extreme temperature seals maximum temperature 400° F (204° C) and minimum temperature -50° F (-45° C).
- ✓ Chain/gear guard is a recommended option, sold separately.

Shown with optional accessories: hose and roller bracket sold separately.

Straight swivel is standard on Series 40 reels. 90° swivel (pictured) available upon request.

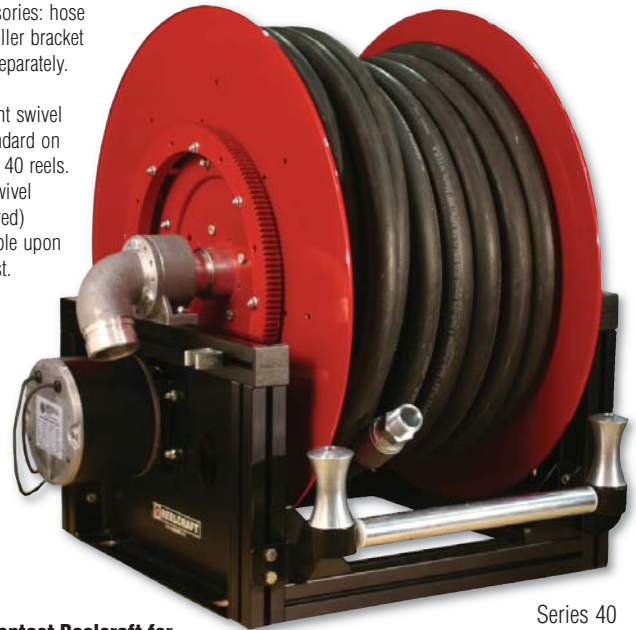

Series 40

Contact Reelcraft for guard, switch and roller brackets.

Also available in standard drive types:

Explosion proof
12VDC
24VDC
115VAC

Pneumatic Motor
Hydraulic Motor
Auxiliary Bevel Crank

Part Number Options 4□1131□□1LC

Hose ID:

- 1 = 1" hose
- 2 = 1¼" hose
- 3 = 1½" hose

Drive Type:

- CG = Hand Crank
- BG = Bevel Crank (only)
- DH = 12VDC, Gear Drive
- EH = 12VDC, Chain Drive

Made in USA

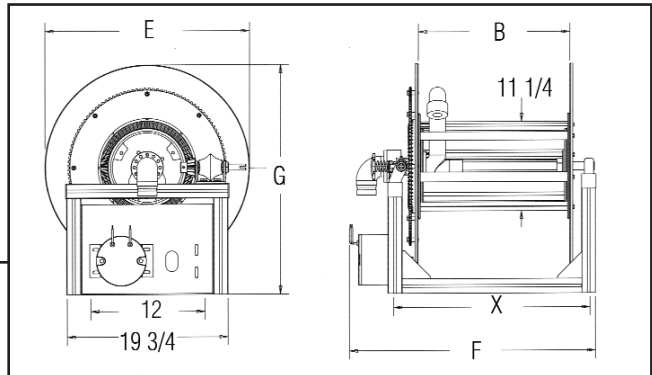

SPECIFICATIONS

MODEL	HOSE LENGTH			B		E		F Bevel		F Electric		G		X				
	ft / m		ft / m		in / mm		in / mm		in / mm		in / mm		in / mm					
A4□1131□□1LC	80	24	50	15	—	—	13	330	21	533	23 3/4	603	25 3/4	654	24	610	18 3/4	476
A4□2081□□1LC	80	24	50	15	—	—	8	203	25	635	17 3/4	451	19 3/4	502	26	660	13 3/4	349
A4□1171□□1LC	100	30	80	24	50	15	17	432	21	533	26 3/4	679	28 3/4	730	24	610	22 3/4	578
A4□2101□□1LC	100	30	80	24	50	15	10	254	25	635	19 3/4	502	21 3/4	552	26	660	15 3/4	400
A4□1321□□1LC	200	61	150	46	100	30	32	813	21	533	41 3/4	1060	43 3/4	1111	24	610	37 3/4	959
A4□2191□□1LC	200	61	150	46	100	30	19	483	25	635	28 3/4	730	30 3/4	781	26	660	24 3/4	629
A4□3131□□1LC	200	61	150	46	100	30	13	330	27	711	26 3/4	679	28 3/4	730	30	762	18 3/4	476
A4□3221□□1LC	325	99	250	76	200	61	22	559	27	711	31 3/4	806	33 3/4	857	29	737	27 3/4	705
A4□4171□□1LC	350	107	275	84	200	61	17	432	31	787	26 3/4	679	28 3/4	730	34	864	22 3/4	578

DIMENSIONS

KEY: Bevel = bevel crank Electric = electric motor

Verify application dimensions and weight requirements prior to ordering.

Installation Note: For the warranty to be valid, a flexible connector MUST be used between the swivel and the inlet piping.

North America: 800-444-3134

Europe: +44 (0) 1536 406999

reelcraft.com

China: +86 (519) 8512 2391

Pacific Rim: +63 (45) 625-6624

Latin America: 260-489-1685

Reelcraft Industries is
ISO 9001:2000
Certified Since 1996

Models listed with an icon can be shipped same day upon request when the order is received by 11:30 AM local time for quantities of 5 or fewer.



Indiana Warehouse



California Warehouse



Indiana & California
Warehouses



Canadian Warehouse

Heavy Duty Large Frame Reels

Nordic™ Series 3900

1½" Fluid Path for 1" through 1½" I.D. Hose

Rewind: Gear-drive rewind (new) or chain and sprocket drive powered by A.C. or D.C. electric motor, compressed air motor or hydraulic motor.

Inlet: 2" straight victaulic with 1½" female NPT straight swivel joint is standard. 2" victaulic 90° with 1½" NPT female available at extra cost.

Gooseneck: 1", 1¼" and 1½" female/male NPT outlet. Other sizes and/or threads can be furnished and must be specified.

ADD 12" to E dimension when crank is in rewind position.
The standard color for this series is red or gray.

NEW!
Gear drive
option

Shown with optional
bevel crank.

**1/2" pitch chain
now standard**

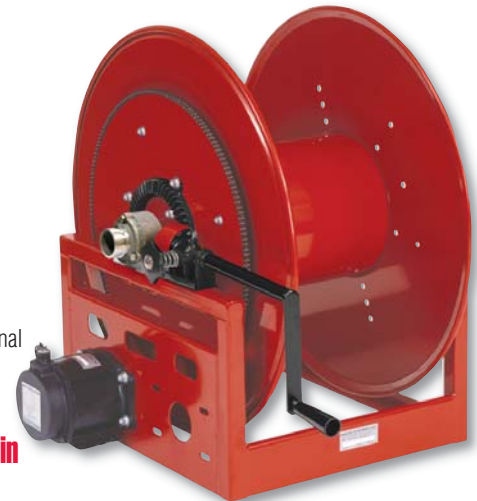

Standard seals maximum temperature 174° F (79° C) and minimum temperature -20° F (-29° C). Extreme temperature seals maximum temperature 400° F (204° C) and minimum temperature -50° F (-45° C) and standard pressures to 600 PSI. Other temperatures or pressures can be furnished at extra cost, consult manufacturer.

Made in USA

Note: Weights shown in chart are for crank rewind models.

Prefix	Type	LB / KG
EP	Electric	42 / 19
A	Air	26 / 12
H	Hyd	26 / 12

Add these amounts and model number prefix for power rewind models.

DIMENSIONS DIAGRAM

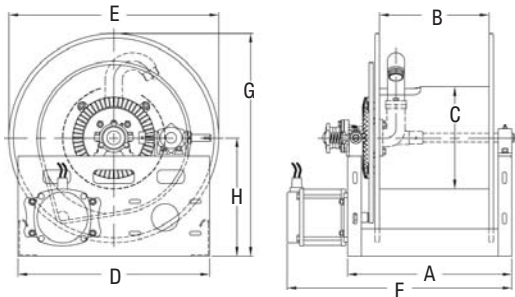

HOSE I.D.	in	1	1 1/4	1 3/8	1 1/2
	mm	25	32	35	38
HOSE O.D.	in	1.563	1.813	2.000	2.063
	mm	40	46	51	52

SPECIFICATIONS - HOSE CAPACITY AND REEL DIMENSIONS

KEY: CRK = hand crank; ELC = electric motor; HYD = hydraulic motor; AIR = air motor; BEVEL = bevel crank

MODEL	HOSE LENGTH (other std. lengths available)				EST. WEIGHT	A	B	C	D	E CRK	E ELC	E AIR	E HYD	F CRK	F ELC	F AIR	F HYD	G	H		
3900-19-16	ft	55	45	45	40	90 LB	in	22	16	11¼	21	21	22	21	26	29	26	28	22½	13	
	m	17	14	14	12	41 KG	mm	559	406	286	533	533	559	533	660	737	660	711	572	330	
3900-19-20	ft	70	65	60	55	93 LB	in	26	20	11¼	21	21	22	21	30	33	30	32	22½	13	
	m	21	20	18	17	42 KG	mm	660	508	286	533	533	559	533	762	838	762	813	572	330	
3900-23-12	ft	95	60	55	50	87 LB	in	18	12	11¼	21	23	23	24	23	25	22	24	24½	13	
	m	29	18	17	15	39 KG	mm	457	305	286	533	584	584	610	584	559	635	559	610	622	330
3900-23-18	ft	155	90	90	80	93 LB	in	24	18	11¼	21	23	23	24	23	28	31	28	30	24½	13
	m	47	27	27	24	42 KG	mm	610	457	286	533	584	584	610	584	711	787	711	762	622	330
3900-23-20	ft	165	105	100	95	95 LB	in	26	20	11¼	21	23	23	24	23	30	33	30	32	24½	13
	m	50	32	30	29	42 KG	mm	660	508	286	533	584	584	610	584	762	838	762	813	622	330
3900-23-26	ft	220	120	110	105	100 LB	in	32	26	11¼	21	23	23	24	23	36	39	36	38	24½	13
	m	67	37	34	32	45 KG	mm	813	660	286	533	584	584	610	584	914	991	914	965	622	330
3900-23-28	ft	240	145	140	135	103 LB	in	34	28	11¼	21	23	23	24	23	38	41	38	40	24½	13
	m	73	44	43	41	47 KG	mm	864	711	286	533	584	584	610	584	965	1041	965	1016	622	330
3900-23-36	ft	320	190	180	175	111 LB	in	42	36	11¼	21	23	23	24	23	46	49	46	48	24½	13
	m	98	58	55	53	50 KG	mm	1067	914	286	533	584	584	610	584	1168	1245	1168	1219	622	330
3900-25-12	ft	95	85	55	50	89 LB	in	18	12	11¼	21	25	25	25	25	22	25	22	24	26½	14
	m	29	26	17	15	40 KG	mm	457	305	286	533	635	635	635	635	559	635	559	610	673	356
3900-25-20	ft	165	155	100	95	97 LB	in	26	20	11¼	21	25	25	25	30	33	30	32	26½	14	
	m	50	47	30	29	44 KG	mm	660	508	286	533	635	635	635	762	838	762	813	673	356	
3900-31-12	ft	210	155	115	105	92 LB	in	18	12	11¼	24	31	31	31	22	25	22	24	32½	17	
	m	64	47	35	32	42 KG	mm	457	305	286	610	787	787	787	559	635	559	610	826	432	
3900-31-16	ft	305	205	155	150	96 LB	in	22	16	11¼	24	31	31	31	26	29	26	28	32½	17	
	m	93	62	47	46	44 KG	mm	559	406	286	610	787	787	787	660	737	660	711	826	432	
3900-31-20	ft	365	275	200	190	100 LB	in	26	20	11¼	24	31	31	31	30	33	30	32	32½	17	
	m	111	84	61	58	45 KG	mm	660	508	286	610	787	787	787	762	838	762	813	826	432	

Refer to page 4 to build a complete model number.

Heavy Duty Large Frame Reels Nordic™ Series 3900 LPG

1½" or 2" Fluid Path for 1" through 2" I.D. Hose

Rewind: Gear-drive or chain and sprocket drive powered by explosion proof A.C. or D.C. electric motor, compressed air motor or hydraulic motor.

Inlet: Full Circle® UL approved swivels available in 1", 1½" and 2" as standard.

Hose Boss™ (optional accessory)

The Hose Boss™ Rewind Assist consists of a rewind switch mounted in an extended arm with two hose rollers. Assists in efficiently and safely unwinding and rewinding hose.

Now available in polished aluminum



Nordic Series 3900 LPG



Inset: Nordic™ Series 3900 LPG with optional Hose Boss™

Heavy Duty Spring Retractable Reels Series 80000/D80000 - ½", ¾", 1" I.D.

OPTIONS

Choose a reel model from the chart below, then use the suffix codes below to choose a flange/ end plate material.

LP82000 OL□

Flange/End Plate Material	
S	Stainless Steel
P	Carbon Steel

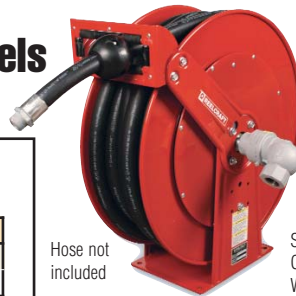

Hose not included

Series 80000 Carbon steel With Full Circle® swivel



Hose Boss™

Made in USA

SPECIFICATIONS - Refer to chart on page 11 for dimensions.

MODEL	HOSE I.D.		HOSE O.D.		CAPACITY	PRESSURE	WEIGHT	A		B		D		E		F	
	in / mm	in / mm	in / mm	in / mm				ft / m	psi / bar	lbs / kg	in / mm	in / mm	in / mm	in / mm	in / mm	in / mm	in / mm
SERIES 80000 / D80000: SPRING DRIVEN REELS																	
LP82000 OL□*	1/2	13	.845	21	100 30	300 21	82 37	24 610	25 3/8	645	15 381	10 254	6 152				
LP83000 OL□*	3/4	19	1.188	30	50 15	500 35	82 37	24 610	25 3/8	645	15 381	10 254	6 152				
LPD83000 OL□*	3/4	19	1.188	30	75 23	500 35	77 35	24 610	25 3/8	645	16 3/8	416	10 1/2	267	7 7/8	200	
LPD84000 OL□*	1	25	1.500	38	50 15	500 35	77 35	24 610	25 3/8	645	16 3/8	416	10 1/2	267	7 7/8	200	

*Choose drive type and flange/end plate material from charts above.

HOSE I.D.	in	1	1 1/4	1 1/2	2
	mm	25	32	38	51
HOSE O.D.	in	1.563	1.813	2.063	2.563
	mm	46	46	52	65

SPECIFICATIONS - HOSE CAPACITY AND REEL DIMENSIONS Refer to chart on page 29 for Series 3900 LPG dimensions.

MODEL	HOSE LENGTH				Est. Weight		A	B	C	D	E	F	G	H
	ft	m	ft	m										
3900-19-20*	ft	75	70	55	103 LB	in	26	20	11.25	21	21	33	22.5	13
	m	23	21	17	47 KG	mm	660	508	286	533	533	838	572	330
3900-23-16*	ft	125	90	75	100 LB	in	22	16	11.25	21	23	29	24.5	13
	m	38	27	23	45 KG	mm	559	406	286	533	584	737	622	330
3900-23-20*	ft	160	125	100	105 LB	in	26	20	11.25	21	23	33	24.5	13
	m	49	38	30	48 KG	mm	660	508	286	533	584	838	622	330
3900-23-24*	ft	200	150	125	110 LB	in	30	24	11.25	21	23	37	24.5	13
	m	61	46	38	50 KG	mm	762	610	286	533	584	940	622	330
3900-25-14*	ft	150	100	65	102 LB	in	20	14	11.25	21	25	27	26.5	14
	m	46	30	20	46 KG	mm	508	356	286	533	635	686	673	356
3900-25-18*	ft	200	150	80	105 LB	in	24	18	11.25	21	25	31	26.5	14
	m	61	46	24	48 KG	mm	610	457	286	533	635	787	673	356
3900-23-26*	ft			90	112 LB	in	32	26	15	21	23	39	24.5	13
	m			27	51 LG	mm	813	660	381	533	584	991	622	330
3900-31-12*	ft			90	102 LB	in	18	12	15	24	31	25	32.5	17
	m			27	46 KG	mm	457	305	381	610	787	635	826	432
3900-31-22*	ft			185	115 LB	in	28	22	15	24	31	35	32.5	17
	m			56	52 KG	mm	711	559	381	610	787	889	826	432

*Refer to page 4 to build a complete model number including LPG swivel.

North America: 800-444-3134

Europe: +44 (0) 1536 406999

reelcraft.com

China: +86 (519) 8512 2391

Pacific Rim: +63 (45) 625-6624

Latin America: 260-489-1685

Reelcraft Industries is
ISO 9001:2000
Certified Since 1996

Models listed with an icon can be shipped same day upon request when the order is received by 11:30 AM local time for quantities of 5 or fewer.



Indiana Warehouse



California Warehouse



Indiana & California
Warehouses



Canadian Warehouse



Nordic Series 5900

Large Frame Reels

Nordic™ Series 3700 and 5900

Heavy Duty Large Frame Reels

Nordic™ Series 3700 & 5900

2", 3" or 4" Fluid Path for 1½" through 4" I.D. Hose

Rewind: Gear-drive crank rewind or chain and sprocket drive powered by A.C. or D.C. electric motor, compressed air motor or hydraulic motor.

Inlet: 2" (Series 3700) / 3" (Series 5900) straight victaulic is standard. 4" (Series 5900) 90° victaulic and 24" diameter drum is standard. 90° victaulic swivel joint available at extra cost.

Gooseneck: 2" (Series 3700) / 3" (Series 5900) / 4" (Series 5900) female NPT. Other sizes and/or threads can be furnished and must be specified.

Series 5900 product temperatures from -50° F to +400° F and standard pressures to 300 p.s.i. Series 3700 standard seals maximum temperature 174° F (79° C) and minimum temperature -20° F (-29° C). Extreme temperature seals maximum temperature 400° F (204° C) and minimum temperature -50° F (-45° C).

Made in USA

HOSE I.D.	in	1 1/2	2	2 1/2	3	4
	mm	38	51	64	76	102
HOSE O.D.	in	2.063	2.563	3.188	3.75	4.75
	mm	52	65	81	95	121

SPECIFICATIONS - HOSE CAPACITY AND REEL DIMENSIONS

Refer to diagram on page 7 for dimension key.

KEY: CRK = hand crank; ELC = electric motor; HYD = hydraulic motor; AIR = air motor

MODEL	HOSE LENGTH					EST. WEIGHT	DIMENSIONS															
							A	B	C	D	E CRK	E ELC	E AIR	E HYD	F CRK	F ELC	F AIR	F HYD	G	H		
3700-23-20	ft	65	25			114 LB	in	26	20	15	21	23	23	24	23	30	33	30	32	24½	13	
	m	20	8			52 KG	mm	660	508	381	533	584	584	610	584	762	838	762	813	622	330	
3700-25-20	ft	65	55			124 LB	in	26	20	15	21	25	25	25	30	33	30	32	26½	14		
	m	20	17			56 KG	mm	660	508	381	533	635	635	635	635	762	838	762	813	673	356	
3700-25-24	ft	80	65			128 LB	in	30	24	15	21	25	25	25	34	37	34	36	26½	14		
	m	24	20			58 KG	mm	762	610	381	533	635	635	635	864	940	864	914	673	356		
3700-25-32	ft	115	90			136 LB	in	38	32	15	21	25	25	25	42	45	42	44	26½	14		
	m	35	27			62 KG	mm	965	813	381	533	635	635	635	1067	1143	1067	1118	673	356		
3700-31-12	ft	90	50			134 LB	in	18	12	15	24	31	31	31	22	25	22	24	32½	17		
	m	27	15			61 KG	mm	457	305	381	610	787	787	787	787	559	635	559	610	826	432	
3700-31-20	ft	165	90			142 LB	in	26	20	15	24	31	31	31	30	33	30	32	32½	17		
	m	50	27			64 KG	mm	660	508	381	610	787	787	787	762	838	762	813	826	432		
3700-31-26	ft	220	125			148 LB	in	32	26	15	24	31	31	31	31	36	39	36	38	32½	17	
	m	67	38			67 KG	mm	813	660	381	610	787	787	787	914	991	914	965	826	432		
3700-39-16	ft	225	140			182 LB	in	22	16	15	24	39	39	39	26	29	26	28	40½	21		
	m	69	43			83 KG	mm	559	406	381	610	991	991	991	660	737	660	711	1029	533		
3700-39-24	ft	350	220			190 LB	in	30	24	15	24	39	39	39	34	37	34	36	40½	21		
	m	107	67			86 KG	mm	762	610	381	610	991	991	991	864	940	864	914	1029	533		
5900-31-16	ft		55	20	15	140 LB	in	22	16	20	24	31	31	31	26	29	26	28	32.5	17		
	m		17	6	5	64 KG	mm	559	406	508	610	787	787	787	660	737	660	711	826	432		
5900-31-24	ft		85	30	25	150 LB	in	30	24	20	24	31	31	31	34	37	34	36	32.5	17		
	m		26	9	8	68 KG	mm	762	610	508	610	787	787	787	864	940	864	914	826	432		
5900-31-32	ft		120	45	35	160 LB	in	38	32	20	24	31	31	31	42	45	42	44	32.5	17		
	m		37	14	11	73 KG	mm	965	813	508	610	787	787	787	1067	1143	1067	1118	826	432		
5900-36-12	ft		60	30	30	146 LB	in	18	12	20	24	36	36	36	22	25	22	24	39	21		
	m		18	9	9	66 KG	mm	457	305	508	610	914	914	914	559	635	559	610	991	533		
5900-36-16	ft		90	50	40	150 LB	in	22	16	20	24	36	36	36	26	29	26	28	39	21		
	m		27	15	12	68 KG	mm	559	406	508	610	914	914	914	660	737	660	711	991	533		
5900-39-12	ft		90	50	35	180 LB	in	18	12	20	24	39	39	39	22	25	22	24	40.5	21		
	m		27	15	11	82 KG	mm	457	305	508	610	991	991	991	559	635	559	610	1029	533		
5900-39-16	ft		135	80	50	200 LB	in	22	16	20	24	39	39	39	26	29	26	28	40.5	21		
	m		41	24	15	91 KG	mm	559	406	508	610	991	991	991	660	737	660	711	1029	533		
5900-39-24	ft		200	120	65	210 LB	in	30	24	20	24	39	39	39	34	37	34	36	40.5	21		
	m		61	37	20	95 KG	mm	762	610	508	610	991	991	991	864	940	864	914	1029	533		

Refer to page 4 to build a complete model number. Refer to diagram on page 7 for dimension key.

Series 3700 and 5900 are shown with optional bevel crank.



Nordic Series 3700



Nordic Series 5900

1/2" pitch chain now standard

Standard pressures to 300 PSI. Other temperatures or pressures can be furnished at extra cost, consult manufacturer. The standard color for this series is red or gray. ADD 12" to E dimension when crank is in rewind position.

North America: **800-444-3134**

China: **+86 (519) 8512 2391**

Europe: **+44 (0) 1536 406999**

Pacific Rim: **+63 (45) 625-6624**

reelcraft.com

Latin America: **260-489-1685**



Heavy Duty Large Frame Reels Petroleum Service

1½" or 2" Fluid Path for 1¼" through 2" I.D. Hose

Rewind: Chain and sprocket drive powered by A.C. or D.C. electric motor, compressed air motor or hydraulic motor. 30° manual rewind assembly.

Inlet: 90° 2" victaulic is standard. Straight swivel joints may be specified at no extra cost.

Gooseneck: 1¼", 1½" or 2" female/male NPT is available. Specify male or female fitting and hose size when ordering.

Brakes and locks: Manual friction brake is standard. Air operated caliper brake is available at extra cost.

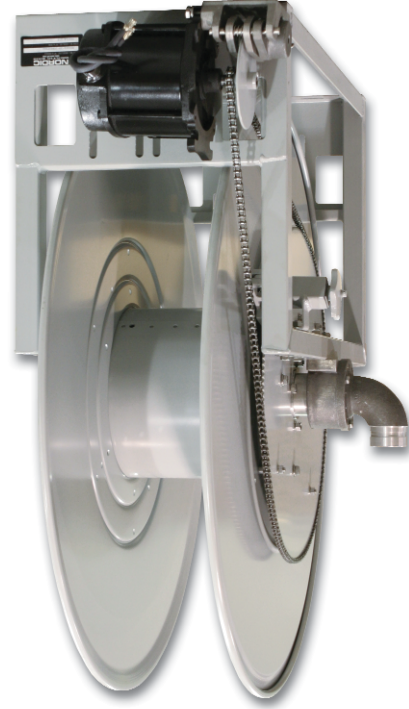

Made in USA

DIMENSIONS DIAGRAM

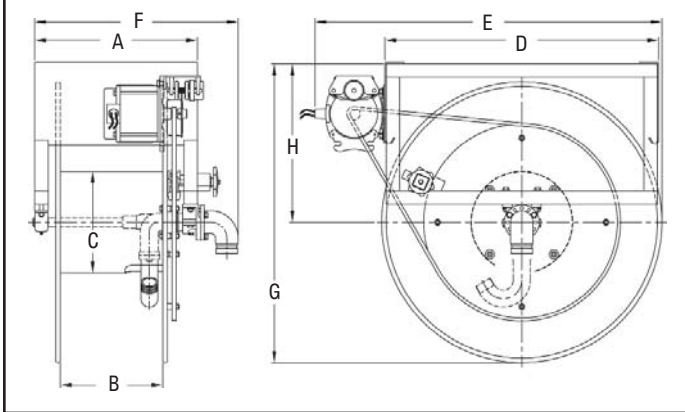

Standard seals maximum temperature 174° F (79° C) and minimum temperature -20° F (-29° C). Extreme temperature seals maximum temperature 400° F (204° C) and minimum temperature -50° F (-45° C). Standard pressures to 300 PSI. Other temperatures or pressures can be furnished at extra cost; consult manufacturer. The standard color for this series is red or gray.

HOSE I.D.		in	1 1/4	1 3/8	1 1/2	2	SPECIFICATIONS - HOSE CAPACITY AND REEL DIMENSIONS								
HOSE O.D.		mm	32	35	38	51									
		in	1.813	2.000	2.063	2.563									
		mm	46	51	52	65									
MODEL	HOSE LENGTH					EST. WEIGHT	A	B	C	D	E	F	G	H	
3800-31-10	ft	130	90	80		174 LB	in	16	10	11.25	30	38.5	20.25	33	17.5
	m	40	27	24		79 KG	mm	406	254	286	762	978	514	838	445
3800-31-12	ft	155	115	105		176 LB	in	18	12	11.25	30	38.5	22.25	33	17.5
	m	47	35	32		80 KG	mm	457	305	286	762	978	565	838	445
3800-31-16	ft	205	155	150		180 LB	in	22	16	11.25	30	38.5	26.25	33	17.5
	m	62	47	46		82 KG	mm	559	406	286	762	978	667	838	445
3800-39-7	ft	120	100	85		212 LB	in	13	17	11.25	32	43.5	17.25	41	21.5
	m	37	30	26		96 KG	mm	330	432	286	813	1105	438	1041	546
3800-39-9	ft	150	135	120		214 LB	in	15	9	11.25	32	43.5	19.25	41	21.5
	m	46	41	37		97 KG	mm	381	229	286	813	1105	489	1041	546
3800-39-11	ft	220	170	155		216 LB	in	17	11	11.25	32	43.5	21.25	41	21.5
	m	67	52	47		98 KG	mm	432	279	286	813	1105	540	1041	546
3800-31-13	ft	120	110	105	60	178 LB	in	19	13	15	30	38.5	24.5	33	17.5
	m	37	34	32	18	81 KG	mm	483	330	381	762	978	622	838	445
3800-39-12	ft	225	180	160	105	218 LB	in	18	12	15	32	43.5	23.5	41	21.5
	m	69	55	49	32	99 KG	mm	457	305	381	813	1105	597	1041	546
3800-39-16	ft	305	245	225	150	224 LB	in	22	16	15	32	43.5	27.5	41	21.5
	m	93	75	69	46	102 KG	mm	559	406	381	813	1105	699	1041	546

Refer to page 4 to build a complete model number.

North America: 800-444-3134

Europe: +44 (0) 1536 406999

reelcraft.com

China: +86 (519) 8512 2391

Pacific Rim: +63 (45) 625-6624

Latin America: 260-489-1685

Reelcraft Industries is
ISO 9001:2000
Certified Since 1996

Models listed with an icon can be shipped same day upon request when the order is received by 11:30 AM local time for quantities of 5 or fewer.



Indiana Warehouse



California Warehouse



Indiana & California
Warehouses



Canadian Warehouse



Large Frame Reels Nordic™ Series 6000

Heavy Duty Single Wrap Reels Petroleum / Aviation Fuel Service

1½", 2" or 3" Fluid Path for 1" through 3" I.D. Hose

Rewind: Chain and sprocket drive powered by A.C. or D.C. electric motor, compressed air motor or hydraulic motor.

Inlet: 2" victaulic is standard for 1" through 2" ID hose. 3" victaulic is standard for 2½" and 3" ID hose. 1½", 2" and 3" NPT or BSPP available. 90° Inlets available at no extra cost.

Gooseneck: 1½", 2" and 3" NPT or BSPP. Specify male or female threads for gooseneck.

Brakes and locks: Air operated caliper brake and idler assembly is standard. Manual friction brake optional.

Materials: Standard frame and spool assembly are of heavy duty steel construction. Also available in aluminum. The standard color for this series is red or gray.

Operating pressure: 300 PSI maximum. Reels to operate at other pressure ratings available at extra cost. Consult manufacturer.

Operating temperatures: Maximum 400°F (204°C) / minimum -40°F (-40°C). Reels that are to operate at other temperatures ratings are available at extra cost, consult manufacturer.



Made in USA

DIMENSIONS DIAGRAM

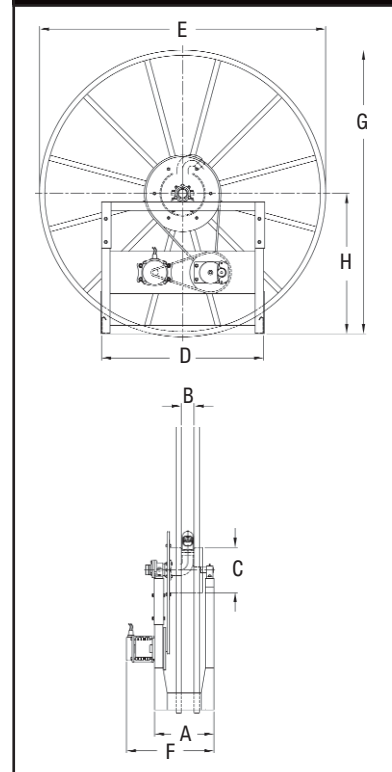

HOSE I.D.	in	1 3/8	1 1/2	2	2 1/2	3
	mm	35	38	51	64	76
HOSE O.D.	in	2.000	2.063	2.563	3.063	3.750
	mm	51	52	65	81	95

*Drum diameter confirms to API 1529 Appendix A.

MODEL	HOSE LENGTH						DIMENSIONS				
							D	E	G	H	
6000-47	ft	55	50	30	25	20	in	38.5	47	48.5	25
	m	17	15	9	8	6	mm	978	1194	1232	635
6000-55	ft	80	75	50	40	35	in	38.5	55	55.75	28.25
	m	24	23	15	12	11	mm	978	1397	1416	718
6000-62	ft	100	100	70	50	50	in	38.5	62	62.75	31.75
	m	30	30	21	15	15	mm	978	1575	1594	806
6000-68	ft	125	120	85	70	60	in	38.5	68	68.75	34.75
	m	38	37	26	21	18	mm	978	1727	1746	883
6000-72	ft	150	140	100	80	70	in	38.5	72	72.75	36.75
	m	46	43	30	24	21	mm	978	1829	1848	933

		DIMENSIONS							
Hose I.D.	Drum* Width	A		B		C		F	
		in	mm	in	mm	in	mm	in	mm
1 3/8"	2.5"	12	305	2.5	64	18	457	18.5	470
1 1/2"	2.5"	12	305	2.5	64	18	457	18.5	470
2"	3.5"	12	305	3.5	89	24	610	18.5	470
2 1/2"	3.5"	13	330	3.5	89	24	610	19.5	495
3"	4.5"	14	356	4.5	114	24	610	20.5	521

Refer to page 4 to build a complete model number.

North America: **800-444-3134**
Europe: **+44 (0) 1536 406999**
reelcraft.com

China: **+86 (519) 8512 2391**
Pacific Rim: **+63 (45) 625-6624**
Latin America: **260-489-1685**



Rely on Reelcraft™

Built Better to Perform Better™



North America and Corporate Headquarters

2842 E. Business Hwy 30
Columbia City, IN 46725-0248
Ph: 800-444-3134 • Fax: 800-444-4587
Ph: 260-248-8188 • Fax: 260-248-2605
reelcraft@reelcraft.com
www.reelcraft.com

Latin America and the Middle East

Thompson International, Inc.
P.O. Box 12958, Ft. Wayne, IN 46866
Ph: 260-489-1685 • Fax: 260-489-0203
info@t-i-i.com
www.reelcraft.com/latinamerica

China

Reelcraft Changzhou Co., Ltd.
Building C, No. 229 HeHai West Road
Changzhou, Jiangsu, China 213022
Ph: +86 (519) 8512 2391 ext. 8002
Fax: +86 (519) 8512 9309
rco@reelcraftchina.com
www.reelcraft.com/china

Europe

Unit 17 • Cronin Courtyard • Weldon South Industrial Estate
Corby • Northamptonshire • NN18 8AG United Kingdom
Ph: +44 (0) 1536 406999 • Fax: +44 (0) 1536 406777
europe@reelcraft.com
www.reelcraft.com/europe

Pacific Rim

P.O. Box 53776, Clark Freeport Zone, Philippines 2023
Ph: +63 (45) 625-6624 • Fax: +63 (45) 321-0643
rap@comclark.com
www.reelcraft.com/asia

Australia

PO Box 6463 BC, Blacktown • NSW 2148, Australia
Ph: +61 (2) 9621 8988 • Fax: +61 (2) 9621 7688
sales@recoila.com
www.reelcraft.com

reelcraft.com

Form # MCAT-001 0910

