

NEW!!

**Equipment
Cleaning
Hose
Reel**

Turf Care Reels



Orchard Ridge Country Club, Fort Wayne, IN

D



Orchard Ridge Country Club, Fort Wayne, IN

B



The Links of Eagle Glen, Columbia City, IN



A

B



The Links of Eagle Glen, Columbia City, IN

E



Wind Things Up With Reelcraft™

Reelcraft Industries is
ISO 9001:2000
Certified Since 1996

www.reelcraft.com

Garden & Landscape Hose Reel & Cart

Great for golf courses, athletic fields, parks & rec.



Reel Hose Cart Package 600698

Orchard Ridge Country Club, Ft. Wayne, IN

		CART SIZE			
		12	305	18	457
		in / mm		in / mm	
	A	Adjustable*			
	B	23 3/4	604	28 3/4	731
	C	18 1/2	464	18 1/4	464

*Handle height of cart is adjustable to 35 5/8", 38 5/8", 41 1/2" or 44 1/2"
Eight 5/16" (8 mm) diameter mounting holes.

1. Respond Faster

React quickly and easily, reduce tangled hoses, power-rewind hose.

2. Reduce Turf Damage

Avoid turf wear and damage from dragging hoses.

3. Save Labor, Save Money

Save labor by improving response time, reduce hose wear by storing on a reel.

4. Enhance Existing System

Provide quick supplemental irrigation to enhance your existing system.

5. Save Equipment

Eliminate the need for a dedicated maintenance vehicle on a reel.

Four possible handle adjustments. See chart.

Durable abrasion resistant baked on powder coat finish

1/2" diameter steel axle

12" or 18" width

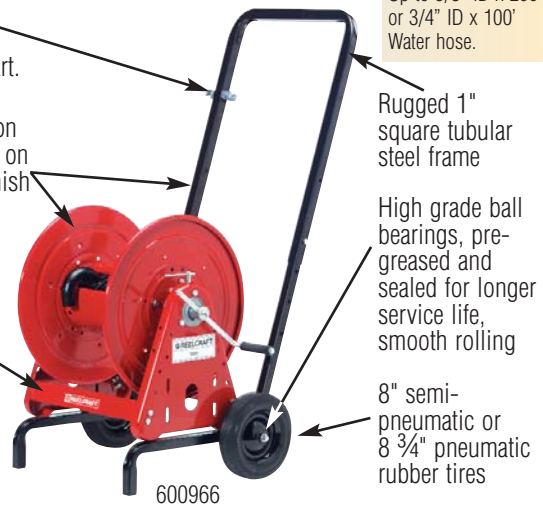

CAPACITY
Up to 5/8" ID x 200'
or 3/4" ID x 100'
Water hose.

HOSE REEL AND CART PACKAGES

PACKAGE	ITEMS INCLUDE:
600965	12" hand crank hose reel with a 1/2" fluid path for 1/2" industrial water hose or 5/8" garden hose, 200' capacity (CA32112 L)
	12" hand cart with pneumatic tires (600741-1) 10' inlet hose (600962)
600966	12" hand crank hose reel with a 1/2" fluid path for 1/2" industrial water hose or 5/8" garden hose, 200' capacity (CA32112 L)
	12" hand cart with semi-pneumatic tires (600741-2) 10' inlet hose (600963)
600967	12" hand crank hose reel with a 3/4" fluid path for 5/8" garden hose or 3/4" industrial water hose, 100' capacity (CA33112 L)
	12" hand cart with pneumatic tires (600741-1) 10' inlet hose (600963)
600968	18" hand crank hose reel with a 1" fluid path for 1" garden hose, 100' capacity (CA37118 L)
	18" hand cart with pneumatic tires (600885-1) 10' inlet hose (600964)



EA37118 L12D

SERIES 30000 REELS

MODEL	TYPE	HOSE I.D.		HOSE O.D.		CAPACITY		WEIGHT		PRESSURE	
		in	mm	in	mm	ft	m	lbs	kg	psi	bar
CA37118 L	Hand Crank	1	25.4	1.38	35	100	30	58	26	300	21
EA37118 L12D	Motor Driven	1	25.4	1.38	35	100	30	75	34	300	21
CA33118 L	Hand Crank	3/4	19.0	1.18	30	150	46	56	25	300	21
EA33118 L12D	Motor Driven	3/4	19.0	1.18	30	150	46	71	32	300	21

600810 Trailer only - does not include reel or hose. Above reels fit trailer dimensions. Trailer weight 154 lbs / 70 kg.

All Series 30000 reels supplied without hose. Assemblies quoted upon request. Inlet is NPTF (F) and matches swivel size. Outlet is 1" NPTF male. **CAUTION:** To prevent drum damage fully extend and pressurize hose and rewind on the reel.

North America: 800-444-3134 Asia: +63 (45) 625-6624
Europe: +44 (0) 1536 406999 Latin America: 260-489-1685

www.reelcraft.com

Reelcraft Industries is
ISO 9001:2000
Certified Since 1996

Professional Turf Care Trailer & Hose Reel

Great for golf courses, athletic fields, parks & rec.



Reel and Trailer Package 600910

Orchard Ridge Country Club, Fort Wayne, Indiana

Trailer #600810 shown (above) with reel model **EA37118L12D** and accessories as follows: operating switch, top and bottom roller guides, battery box, battery connector, chain guard, 10' inlet hose and 1" I.D. by 100' hose. Order reel and trailer package #600910.

Reelcraft's rugged, self-contained hose reel trailer easily attaches to most off-road vehicles or carts and is pre-drilled 12" and 18" for Reelcraft's Series 30000 hose reels. Reels hold up to 150' of 3/4" I.D. (CA/EA33118 L12D) or 100' of 1" I.D. (CA/EA37118 L12D) water hose. Makes spot watering on golf courses easier, quicker and more convenient. Applications include golf courses, athletic fields, sports turfs, grounds maintenance, parks & rec, agriculture and nurseries.

CAPACITY

1" ID x 100' or
3/4" ID x 150'
Water hose.



Reel and Trailer 600910 shown with optional accessories

HOSE REEL AND CART PACKAGES

PACKAGE		ITEMS INCLUDE:
1" Reel	3/4" Reel	
600911	602072	Trailer (600810) Hand rewind hose reel (CA3*118 L) Roller bracket, top wind (600848-3) 10' Lead Hose
600910	602071	Trailer (600810) Motor Driven hose reel (EA3*118 L12D) Switch (S600808) Battery Box (600812) Chain Guard (600518) 10' Lead Hose Roller Bracket, top wind (600848-3) Roller Bracket, bottom wind (600226-3)

For 1" Reel, * = 7. For 3/4" Reel, * = 3. See Series 30000 chart.

HOSE ASSEMBLIES

PART NUMBER	I.D. in.	O.D. in.	INLET in.	END FITTING in.	LENGTH ft.	MAX PSI psi	WEIGHT lbs.
601046-100	5/8	1	3/4 NPTF	3/4 NH (M)	100	200	28
601046-125	5/8	1	3/4 NPTF	3/4 NH (M)	125	200	35
601046-175	5/8	1	3/4 NPTF	3/4 NH (M)	175	200	49
601044-100	3/4	1.18	3/4 NPTF	3/4 NH (M)	100	250	25
601044-150	3/4	1.18	3/4 NPTF	3/4 NH (M)	150	250	38
601065-50	1	1.38	1 NH	1 NH (F)	50	250	21
601065-100	1	1.38	1 NH	1 NH (F)	100	250	42

TRAILER DIMENSIONS

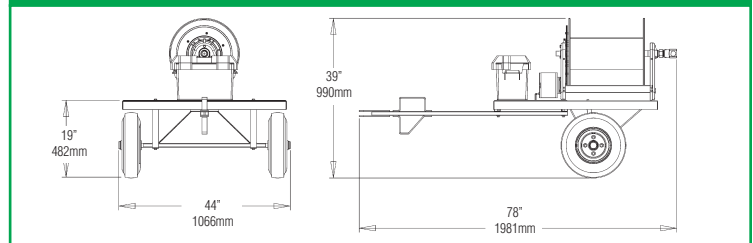

Trailer designed for off-road use only, not for passenger transport. Maximum weight capacity 400 pounds. Maximum speed 15 miles per hour. Trailer, reel and accessories sold separately.

ADDITIONAL ACCESSORIES

- S600808**
Operating switch
- 600848-3**
Top hose roller guide
- 600226-3**
Bottom hose roller guide
- 600518**
Chain guard
- 600812**
Battery box (battery not included)
- 600814**
Battery cable connector
- 600829-10**
Inlet hose, 1" I.D. X 10'



AIR & WATER HOSE ASSEMBLY
LOW PRESSURE

North America: 800-444-3134 Asia: +63 (45) 625-6624
Europe: +44 (0) 1536 406999 Latin America: 260-489-1685

www.reelcraft.com

Reelcraft Industries is
ISO 9001:2000
Certified Since 1996

TURF CARE REELS

Equipment Cleaning Hose Reels

Equipment Cleaning Hose Reels

Great for golf courses, athletic fields, parks & rec.

Equipment Cleaning HOSE REELS

Use air to clean carts and utility vehicles prior to washing to reduce water usage and cut down on clipping mess.



- ▶ **POLYCRAFT**
SGA3650 OLP
3/8" x 50'
With hose.
- SGA3850 OLP
1/2" x 50'
With hose.

Large Capacity HOSE REELS

SERIES 40 HAND CRANK

Suggested models:
411171CG1LC
up to 1" X 100'
432191CG1LC
up to 1-1/2" X 100'
Both without hose.

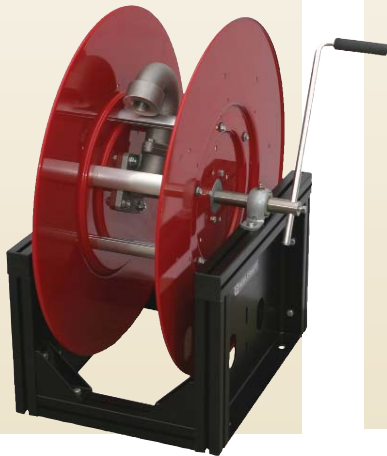

Improve hose management at each wash pad station with Reelcraft reels.

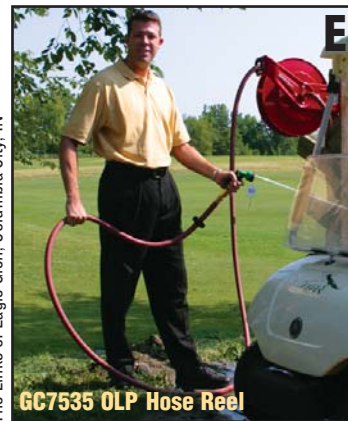

The Links of Eagle Glen, Columbia City, IN

Pressure Wash HOSE REELS

Use to wash carts, utility vehicles and mowers. Available in several packages, see other side.



- ▶ **SERIES H18000**
H18006 M
3/8" x 100'
Hose sold separately.

- ▶ **SERIES 30000**
CA38112 M
Up to 200' x 1/2"
HAND CRANK
3000 PSI.
Hose sold separately.



Wash Pad HOSE REELS

Wash pad application, reels to remain pressurized and tied into irrigation system complete with supply hose and shut off valve for fingertip control.



Lead hose included with wash pad reels.

NEW

- ▶ **SERIES 7000**
GC7925 OLP
3/4" x 25'
With hose.



- ▶ **SERIES 7000**
GC7535 OLP
5/8" x 35'
With garden hose.



North America: 800-444-3134 Asia: +63 (45) 625-6624
Europe: +44 (0) 1536 406999 Latin America: 260-489-1685

www.reelcraft.com



Wind Things Up With Reelcraft™

TURF CARE REELS

Maintenance Hose Reels

Maintenance Facility Hose Reels

Great for golf courses, athletic fields, parks & rec.

Light & Power CORD REELS

FLUORESCENT LIGHT
L 4050 162 2 - 50' of cord



POWER CORD
L 4545 123 3A
Female end; 45' #12/3
20 AMP/115 Volts

INCANDESCENT LIGHT
L 4050 163 1 - 50' of cord
With female receptacle



High Volume WATER HOSE REELS

Ideal for rapid filling of chemical, sprayer or other equipment tanks, or remote equipment cleaning.

D 80000 SERIES
D 84050 OLP
1" x 50' w/ hose.



Welding HOSE REELS

Oxy-Acetylene for safety located next to overhead door, allows for less refilling and handling.

TW SERIES
TW 7460 OLPT
Dual 1/4" x 60 w/ hose.



Illuminate your work area with retractable lights.

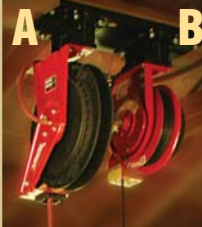

Shown above:
SERIES RT
RT650-OLP
RETRACTABLE LIGHT
L 4050 162 2

Air & Water HOSE REELS

4625 OLP
3/8" x 25'
4435 OLP
1/4" x 35'
Both with hose.



5650 OLP
3/8" x 50'
A5850 OLP
1/2" x 50'
Both with hose.



SERIES-RT
RT650-OLP
3/8" x 50'
RT450-OLP
1/4" x 50'
Both with hose.

SERIES 7000
7850 OLP
1/2" x 50'
7670 OLP
3/8" x 70'
Both with hose.



Turf Care Facility HOSE REELS

Used to keep hoses & cords organized and out of the way.

SERIES 80000
82100 OLP
83050 OLP
3/4" x 50'



North America: 800-444-3134 Asia: +63 (45 599-3721
Europe: +44 (0) 1536 406999 Latin America: 260-489-1685

www.reelcraft.com

REELCRAFT

Wind Things Up With Reelcraft

Reel Hose
Cart Package
600698

Orchard Ridge Country Club
Fort Wayne, IN



△MCAT-001



△1122-802



△737-1194



△1068-800



△1123-802

Work Smarter

Reelcraft Industries, Inc. U.S. Corporate Headquarters

One Reelcraft Center • P.O. Box 248
Columbia City, IN 46725-0248
Ph: 800-444-3134 • Fax: 800-444-4587
Ph: 260-248-8188 • Fax: 260-248-2605
e-mail: reelcraft@reelcraft.com
www.reelcraft.com

Canada

1705 Argenta Rd. Unit #7
Mississauga, ON L5N 3A9
Ph: 800-444-3134
Fax: 800-444-4587
e-mail: reelcraft@reelcraft.com

Latin America & The Middle East

Thompson International, Inc.
P.O. Box 12958
Ft. Wayne, IN 46866
Ph: 260-489-1685
Fax: 260-489-0203
e-mail: info@t-i-i.com
www.reelcraft.com/latinamerica

Europe

Unit 17 • Cronin Courtyard
Weldon South Industrial Estate
Corby • Northamptonshire • NN18 8AG
United Kingdom
Ph: + 44 (0) 1536-406999
Fax: + 44 (0) 1536-406777
e-mail: europa@reelcraft.com
www.reelcraft.com/europe

Asia Pacific

P.O. Box 53776
Clark Freeport Zone
Philippines 2023
Ph: +63 (45) 625-6624
Fax: +63 (45) 321-0643
e-mail: rap@comclark.com
www.reelcraft.com/asia

Australia

Recoila
PO Box 6463 BC, Blacktown,
NSW 2148, Australia
Ph: +61 (2) 9621 8988
Fax: +61 (2) 9621 7688
sales@recoila.com



Form #TCR_0708

Wind Things Up With Reelcraft™

reelcraft.com

Reelcraft Industries is
ISO 9001:2000
Certified Since 1996